

# Proposed Annexation Beaver Dam Road Area

Existing SSD Proposed Area

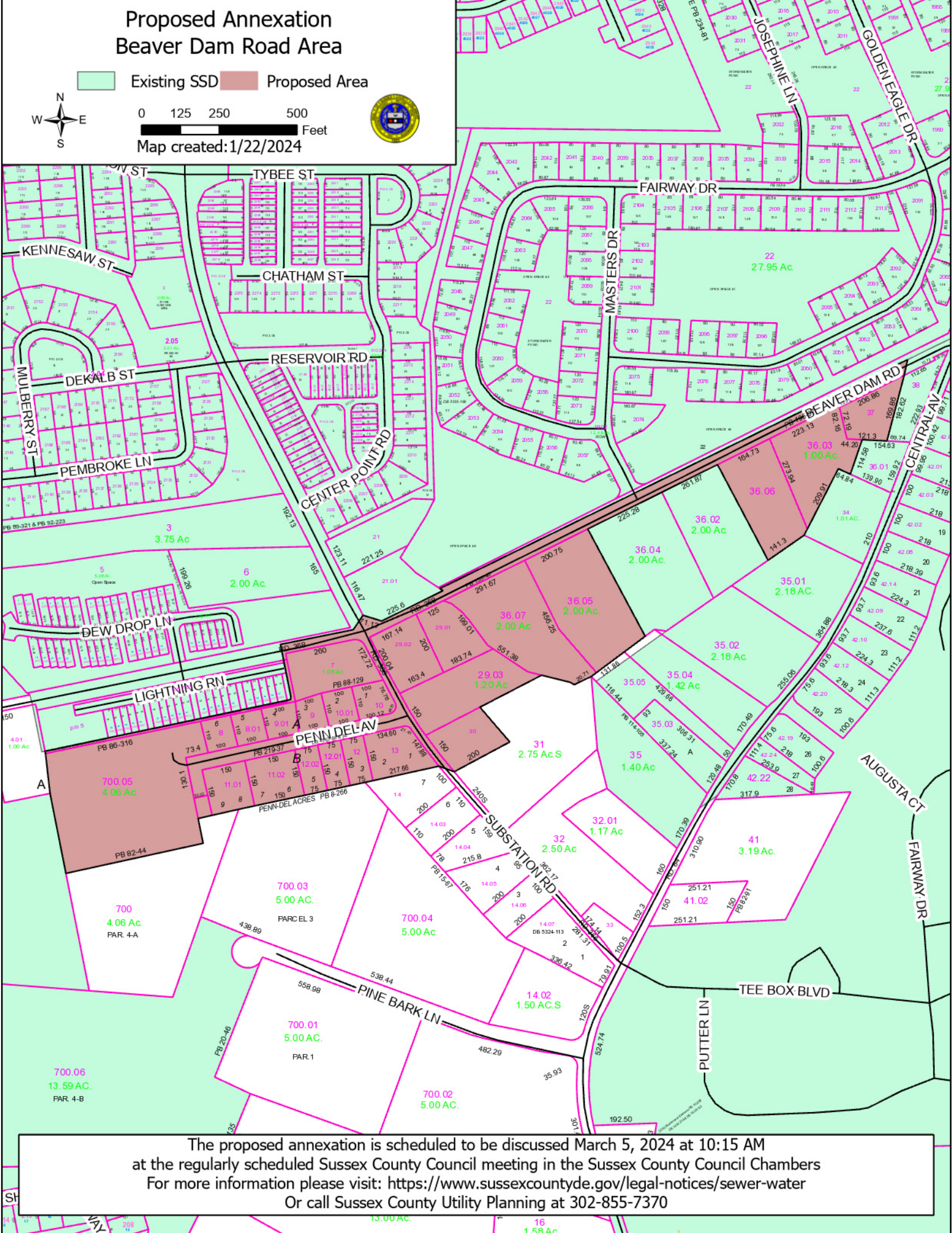

0 125 250 500  
Feet  
Map created: 1/22/2024



The proposed annexation is scheduled to be discussed March 5, 2024 at 10:15 AM  
at the regularly scheduled Sussex County Council meeting in the Sussex County Council Chambers  
For more information please visit: <https://www.sussexcountyde.gov/legal-notice/sewer-water>  
Or call Sussex County Utility Planning at 302-855-7370