

PROPOSED ANNEXATION Bridgeville Warehouses

Existing SSD TMP 131-19.00-4.00 & 5.00

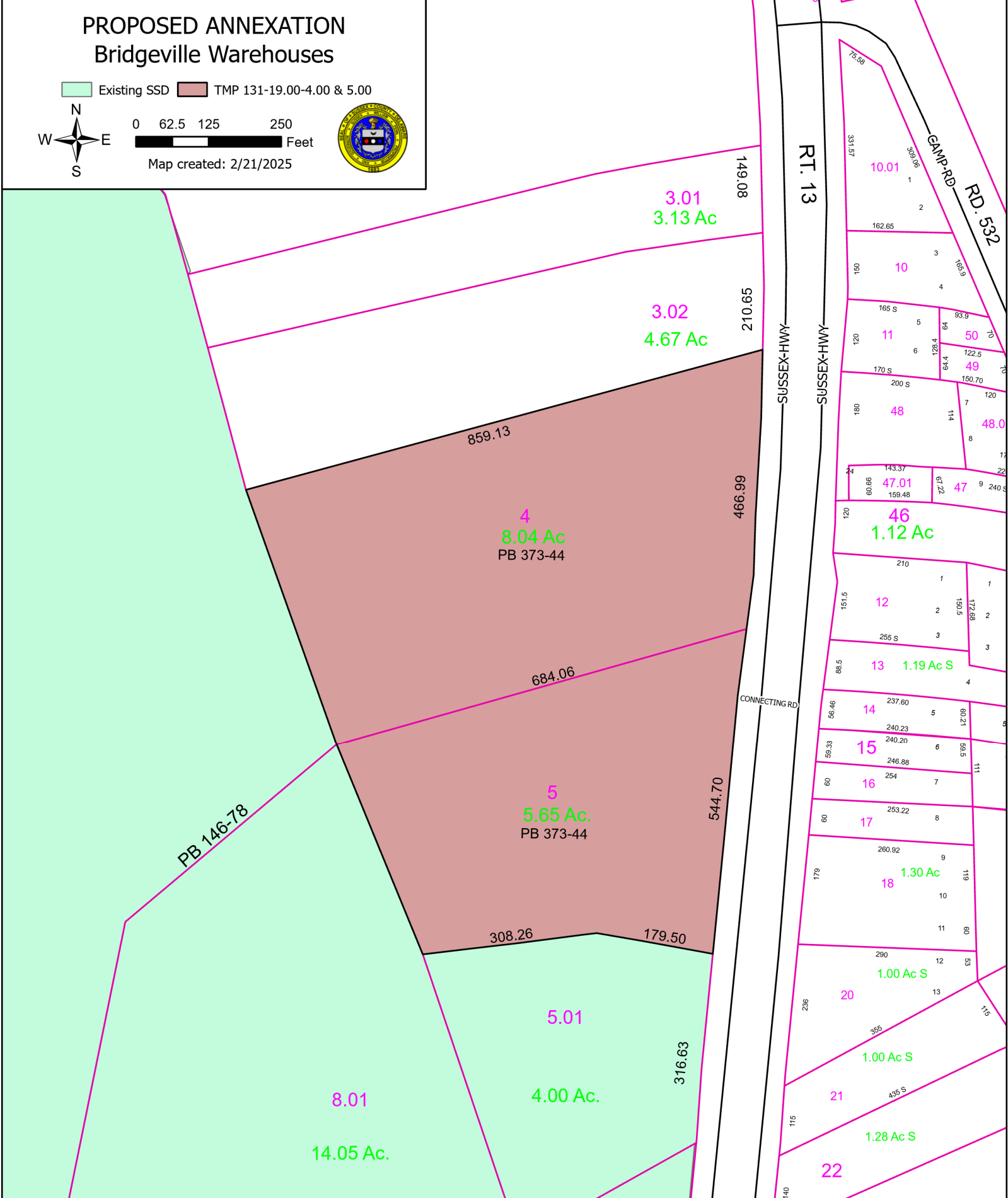

Map created: 2/21/2025



The proposed annexation is scheduled to be discussed March 25, 2024 at 1:30 PM
in the Sussex County Council Chambers
For more information please visit: <https://sussexcountyde.gov/proposed-projects-schedules>
Or call Sussex County Utility Planning at 302-855-7370