

Sussex County Engineering Department

Proposed Indian River Acres Area of the
Sussex County Unified Sanitary Sewer District

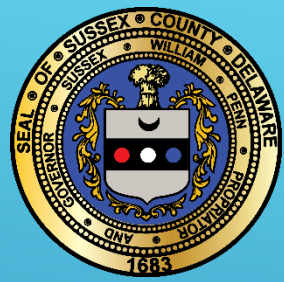

Public Hearing
Community Lutheran Church
30897 Omar Road
Frankford DE
November 20, 2021 @ 9:00AM



Project Background/Information

1. The County has received more than the 50 Petitions required by Delaware Code to move forward with the question of creating a new sanitary sewer district.
2. This is the required Public Hearing on the proposed boundary, we will allow requests for inclusion or exclusion and the County Engineer will determine if any or all requests can be granted.
3. The Engineering Department will present to County Council a Resolution defining the final boundary for referendum.
4. Engineering Department advertises & conducts Referendum on the establishment of the sewer district(s).
5. County Council shall issue a determination on the referendum establishing the District.
6. Engineering & Finance Departments will apply for State and Federal funding.
7. Engineering Department will complete final design once funding has been received.
8. Consultant Engineers will develop bid documents.
9. Engineering Department will accept bids for the project and County Council may award contract based the departments recommendation.
10. **Overall time for completion up to 36-48 months.**

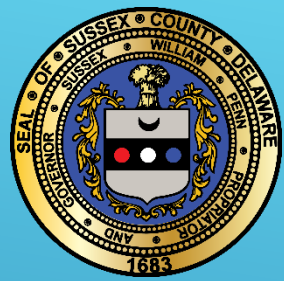

Proposed Boundary

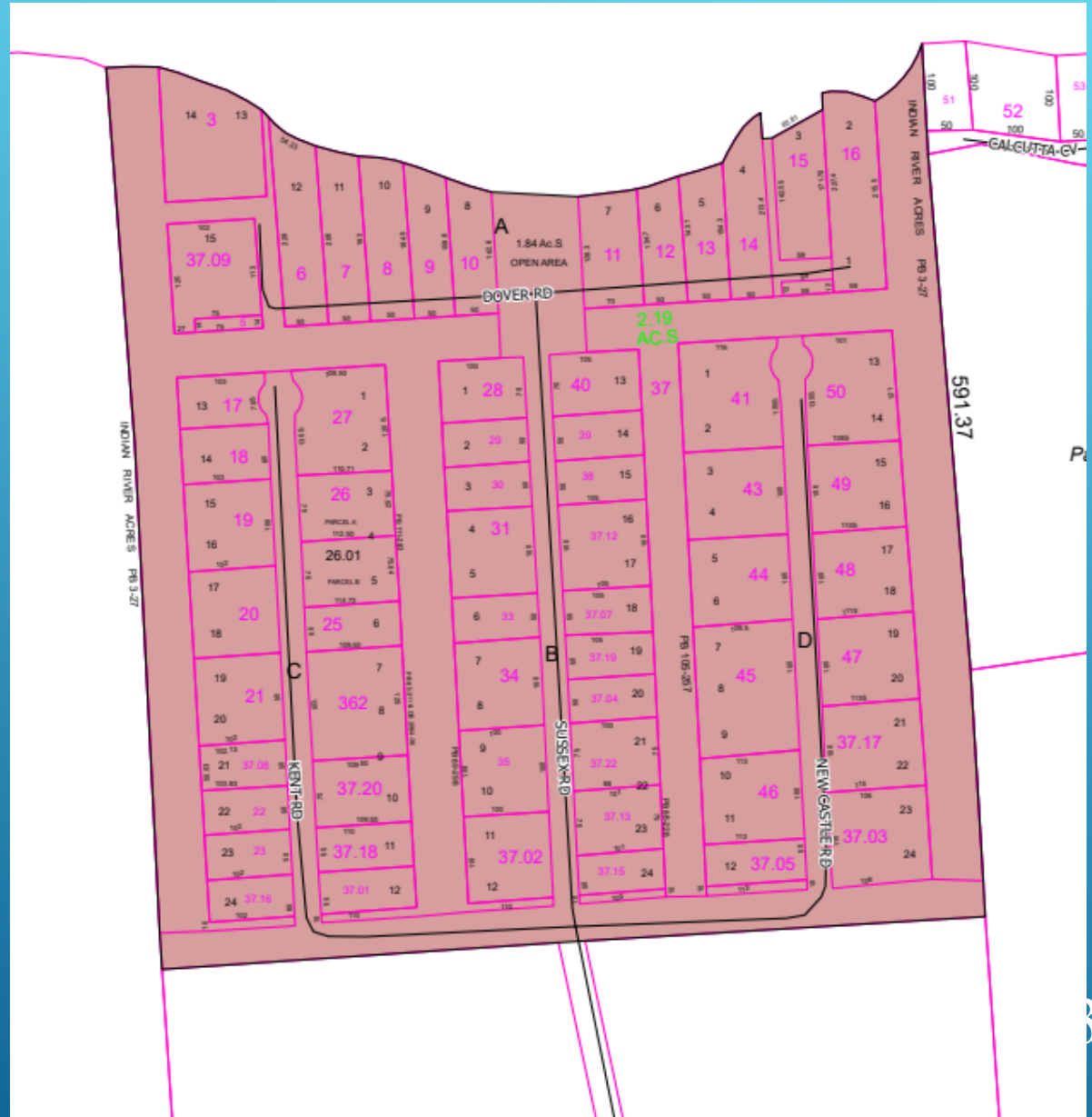



Surrounding Area

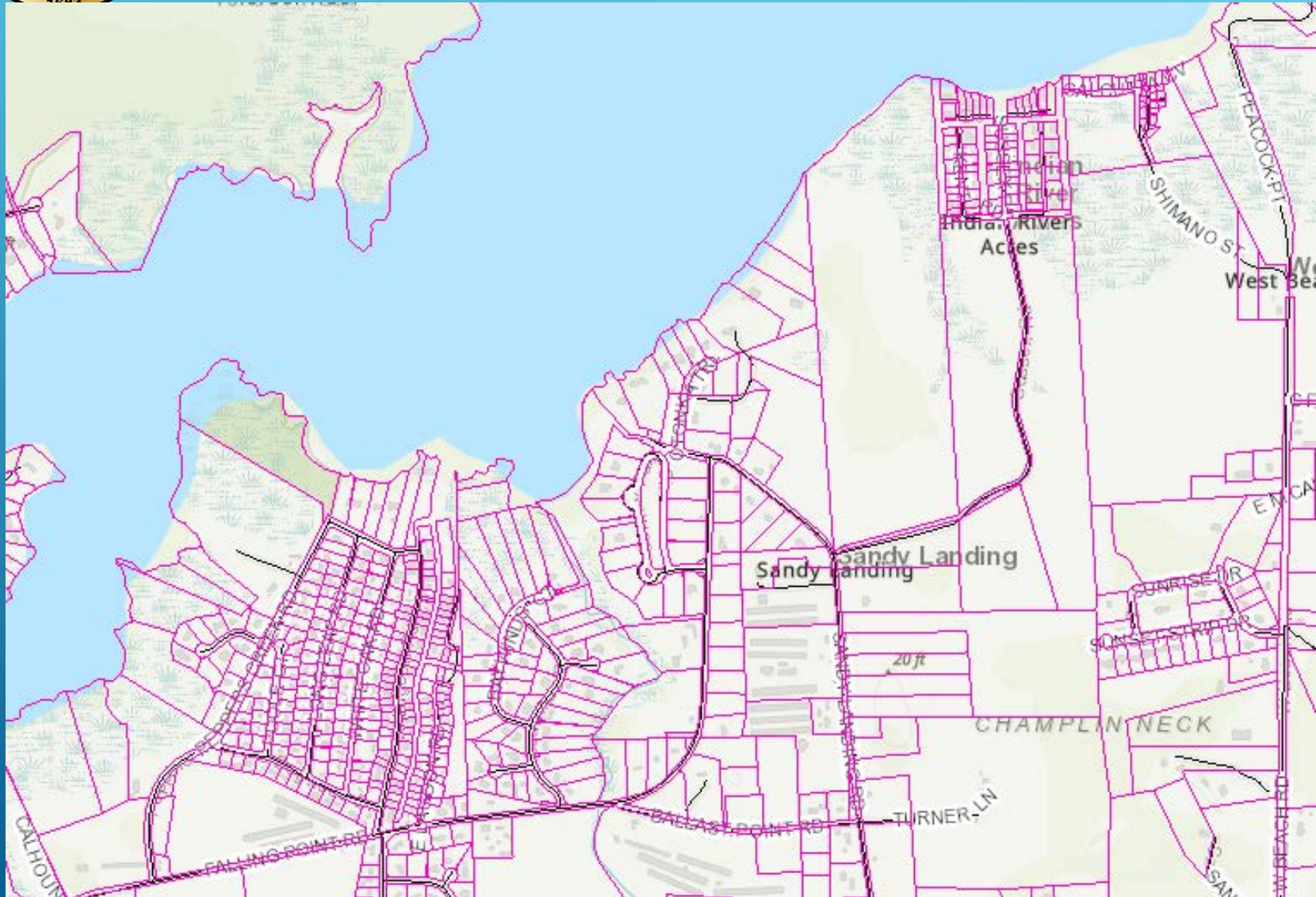

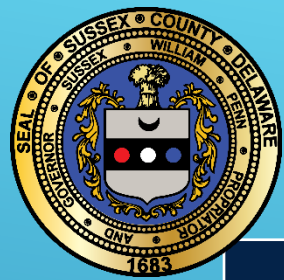

Proposed Project Schedule

Time Frame	Phase
November 20, 2021	Public Hearing on the Boundary
December 2021	County Council to adopt Final Boundary
Noon day prior to referendum	Absentee Ballot Deadline @ 12:00 noon
April 2022	Referendum 9:00am – 1:00pm
Winter 2022*	Complete Facilities Plan & Environmental Assessment
Spring 2023*	Design Phase begins
Fall/Winter 2023*	Advertising/Bidding Phase
Spring 2024*	Begin Construction
Winter 2024*	Project Start-up

* Depends on the outcome of the Referendum

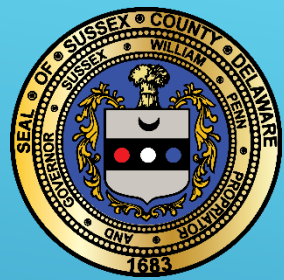

DISCUSSION POINTS

1. The County will need to install sewer lines and a pump station within Indian River Acres as well as install transmission infrastructure to an existing connection point.
2. The County will evaluate different methods, using life cycle costs, for providing sewer service to Indian River Acres summarized in a Preliminary Engineering Report.
3. Any roadways disturbed by the sewer construction will be replaced with hot mix in accordance with most recent County or State Road Standards.
4. Existing septic tanks are pumped, partially collapsed and backfilled; drain fields will be abandoned in place. Mound Systems can remain in place or can be removed.
5. Property owners are responsible for existing septic tank abandonment in accordance with DNREC regulations.
6. After connection Homeowners will only be responsible for lateral between future County clean-out and residence.

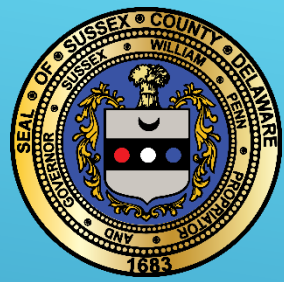

General County Rate Structure

A. Annual

1. Service Charge – Billed Quarterly– Uniform across all Areas

Recovers the costs of operating and maintaining the collection system, transmission system, and treatment facilities. It also recovers all debt service for the regional facilities.

2. Assessment Charge – Billed Annually – Per EDU

Recovers the cost of constructing the sewer system based on the annual bond payments.

B. One-time

1. System Connection Charge – (“Impact Fee.”) - Uniform across all Districts

Paid before hookup for existing homes or before building permits are issued for new homes. Contributes towards debt retirement and future expansion or replacement of transmission and treatment facilities.

2. Permit Fee – Uniform across all Districts

Paid at the time of sewer permit application covering sewer lateral inspection and creation of billing records.

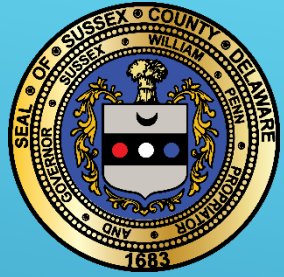

General User Rate Information

1. Assessment charge billing begins when the sewer district infrastructure system becomes operational.
2. System connection is mandatory by code for all homes and/or businesses .
3. Service charge billing begins when a home or business is connected or at mandatory connection deadline.
4. Vacant lots will pay an assessment fee of one equivalent dwelling unit.
5. Financial assistance is available to qualified homeowners.
6. A single-family residence is one equivalent dwelling unit (EDU). A commercial business will be rated as multiple EDUs based on fixture units in accordance with County Code.

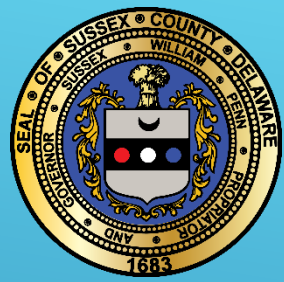

Indian River Acres Specific Estimated Rates

Estimated Annual Service Charge:

\$300/year per Equivalent Dwelling Unit; billed quarterly to connected customers (subject to change during the annual budget process).

Estimated Annual Assessment Charge:

\$900.00/year per Equivalent Dwelling Unit (fixed for the term of the financing)

System Connection Charge:

\$0.00 for homes existing at the time of substantial completion. The one-time System Connection Charge (SCC) fee will be included in the financing. Any future connection will be charged the SCC fee in effect at that time.

Estimated Annual Charge:

\$300 (service charge) + \$900 (assessment fee) = \$1,200 *

Estimated Connection Expenses:

Plumbing costs between \$1500 - \$2000 based on the complexity and \$100 Permit Fee to Sussex County.

* Based on federal recommendations that the total annual charge not to exceed 1.5% of Median Household Income (MHI) as reported in the latest available Sussex County wide Census Data.

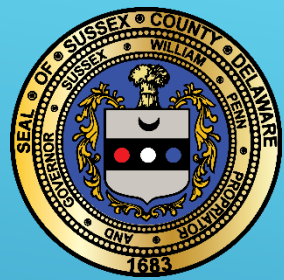

Absentee Ballots

- Available through the Sussex County Engineering Department (SCED) only after County Council has adopted the boundary.
- Contact Mrs. Sharon Smith at (302) 855-7706
- Requests can be made immediately following the adoption of the boundary.
- This is a multiple step process, please request early to allow time for the mailings.
- Ballots are due back at the Sussex County Engineering Department before 12:00 noon the day prior to the referendum per County Code.

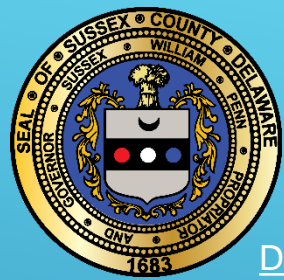

Eligible Voters

DEFINITION OF VOTER PER STATE LAW

- (a) Notwithstanding any other provisions of this title, for the purpose of this chapter the terms "voter," "legal voters," and "elector" shall be deemed to include all the following persons:
- (1) Persons whose principal place of abode has been within the proposed sanitary and water district for at least six months immediately preceding the date of the election or the date of the petition, whichever is applicable;
 - (2) Persons who own real estate in the proposed sanitary and water district on the date of the election or the date of the petition, whichever is applicable, regardless of where they reside, unless such real estate is subject to a lease described in paragraph four of this subsection;
 - (3) Corporations which own real estate in the proposed sanitary and water district on the date of the election or the date of the petition, whichever is applicable, unless such real estate is subject to a lease described in paragraph four of this subsection;
- (b) No person or corporation shall be entitled to more than one vote in any election.
- (c) Jointly or severally owned real estate shall be entitled to only one vote.
- (d) The president or vice-president of a corporation shall exercise the vote on behalf of the corporation,
provided that such president or vice-president exhibits a notarized resolution of the corporation authorizing him to cast such vote.

Source: 9 Delaware Code, Section 6519

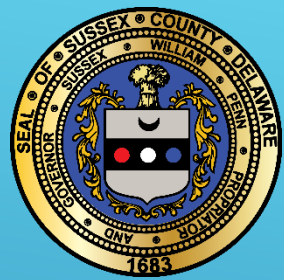

Questions / Comments

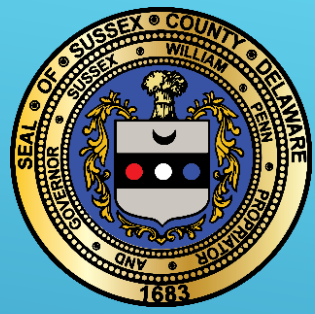

Sussex County Engineering Department

P.O. Box 589

Georgetown, DE 19947

www.sussexcountyde.gov

Project Questions:

Utility Planning & Design Review Division: 302-855-7370

John Ashman (Division Director)

jashman@sussexcountyde.gov

Assessment & Billing Questions:

Billing Division: 302-855-7871

Katrina Mears (Billing Service & Collections Manager)

kmears@sussexcountyde.gov