

Proposed Annexation Leeward Chase

Existing SSD Parcels of Interest



0 100 200 400
Feet

Map created: 3/6/2024

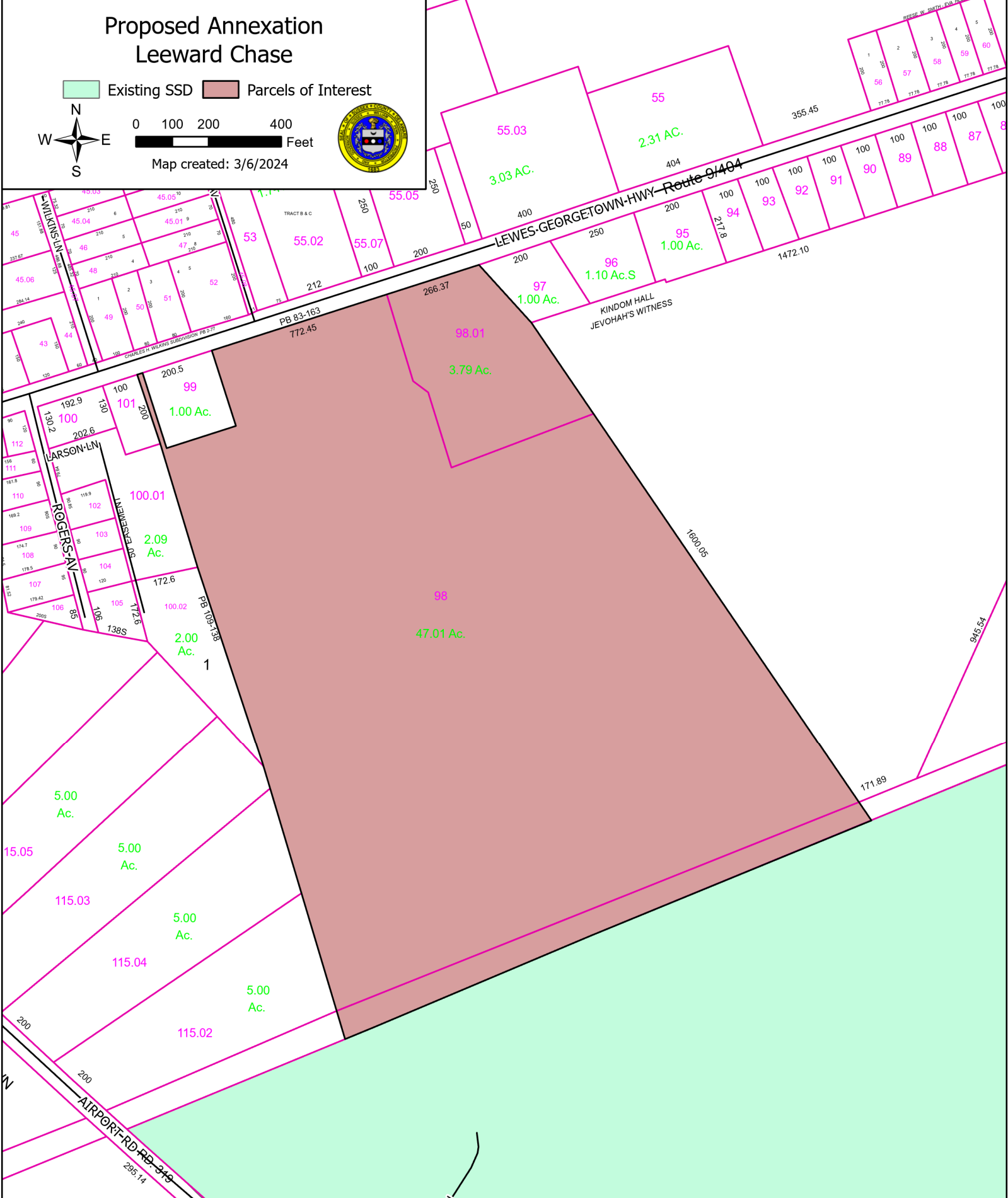

The proposed annexation is scheduled to be discussed April 16, 2024 at 1:30 PM
in the Sussex County Council Chambers
For more information please visit: <https://sussexcountyde.gov/proposed-projects-schedules>
Or call Sussex County Utility Planning at 302-855-7370