

# PROPOSED ANNEXATION Love Creek MHC

Existing SSD    TMP 334-18.00-32.00

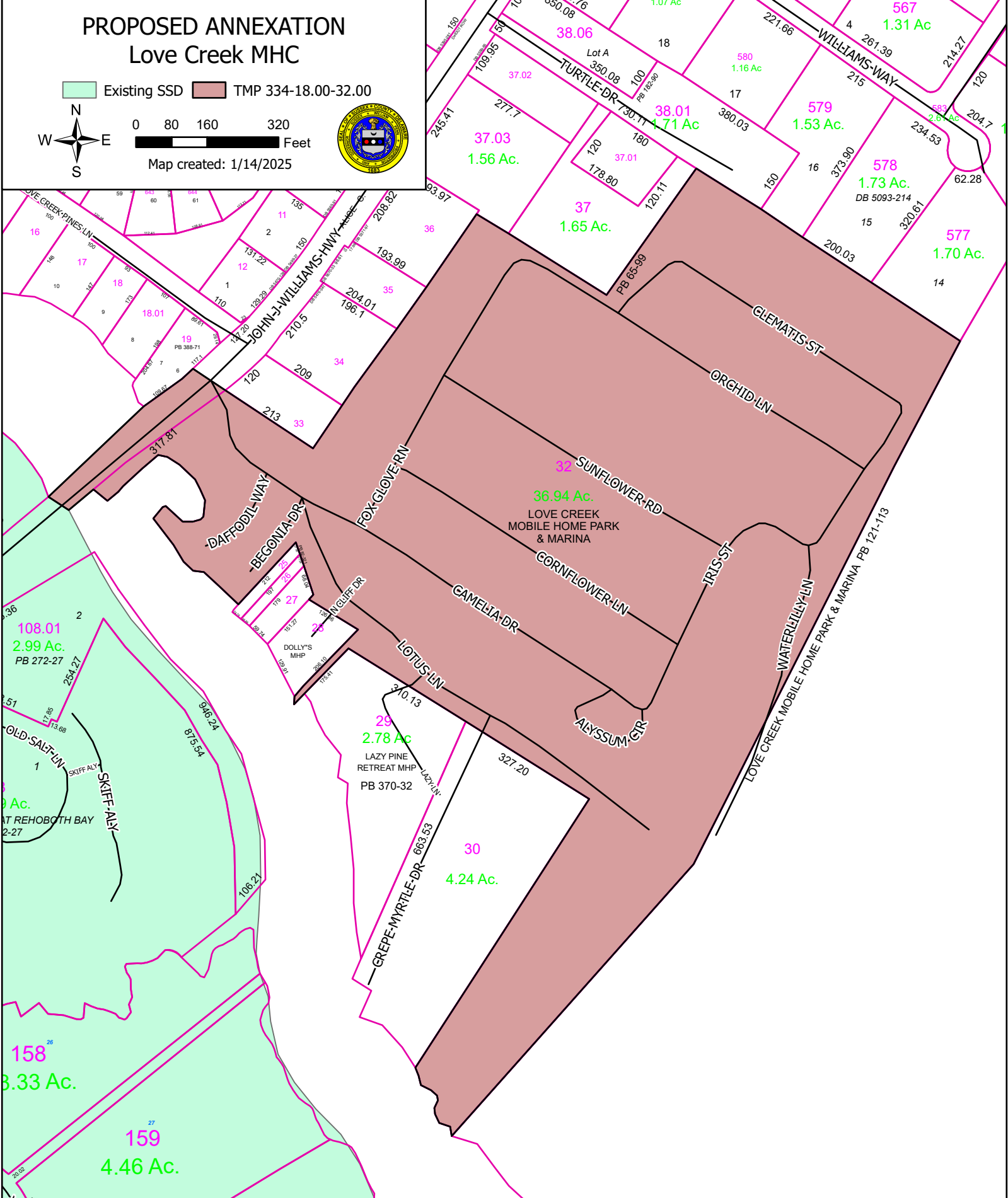

0 80 160 320 Feet  
Map created: 1/14/2025



The proposed annexation is scheduled to be discussed February 4, 2025 at 1:30 PM  
in the Sussex County Council Chambers  
For more information please visit: <https://sussexcountyde.gov/proposed-projects-schedules>  
Or call Sussex County Utility Planning at 302-855-7370