

RESOLUTION NO. R 002 25

A RESOLUTION TO EXTEND THE BOUNDARY OF THE SUSSEX COUNTY UNIFIED SANITARY SEWER DISTRICT (SCUSSD) ANGOLA NECK AREA, TO include THE LOVE CREEK MHP & MARINA AND PARCELS 334-18.00-25.00, 26.00, 27.00, 28.00, 29.00 & 30.00, ON THE south SIDE OF JOHN J. WILLIAMS HIGHWAY LOCATED IN THE LEWES & REHOBOTH HUNDRED, SUSSEX COUNTY, DELAWARE AND RECORDED IN THE OFFICE OF THE RECORDER OF DEEDS, IN AND FOR SUSSEX COUNTY, DELAWARE.

WHEREAS, Sussex County has established the Sussex County Unified Sanitary Sewer Sanitary Sewer District (SCUSSD); and

WHEREAS, in the best interests of the present district and to enhance the general health and welfare of that portion of Sussex County in the vicinity of Love Creek, the inclusion of this area will be beneficial; and

WHEREAS, in accordance with 9 Del.C., Section 6502 (a), the Sussex County Council may, upon request of the County Engineer, revise the boundary of an established sewer district when 50 or more houses have been connected by posting a public notice in four public places in the district describing the new or revised boundary; and

WHEREAS, the Sussex County Council has caused to be posted a public notice in at least four public places in the district, as verified by the affidavit of Phillip C. Calio, a copy of which affidavit and public notice is attached hereto and made a part hereof; and

WHEREAS, in accordance with 9 Del.C., Section 6502 (b), the Sussex County Council shall, within ninety days after posting the public notices pass a formal resolution establishing the new boundary of the district;

NOW, THEREFORE, BE IT RESOLVED the Sussex County Council hereby revises the boundary of the SCUSSD to encompass the lands mentioned above in the Love Creek area and further described as follows:

Beginning at a point, said point being a property corner of lands N/F of State of Delaware Department of Transportation, said point also being on the SCUSSD boundary, said point further being on the northerly ROW of John J. Williams Highway (Rt. 24); thence leaving said SCUSSD boundary and proceeding in a northeasterly direction across Love Creek a distance of 300'± to a point, said point being the southeasternmost property corner of lands N/F of Glenn A. Kuszyk and Jannetta C. Klink, said point also being on the northerly ROW of John J. Williams Hwy (Rt. 24); thence proceeding in a northeasterly direction a distance of 157'± to a point; thence leaving said ROW and proceeding in a southeasterly direction a distance of 85' to a point, said point being on the southeasterly ROW of John J. Williams Hwy (Rt. 24), said point also being on northwesternmost property corner of Love Creek MHP & Marina; thence leaving said ROW and proceeding with said MHP boundary in a southeasterly, northeasterly, southeasterly, northeasterly, southeasterly, southwesterly and northwesterly direction respectively a total distance of 4,600'± to a point; thence leaving said MHP boundary and proceeding by and with the northern shore of Love Creek in a northwesterly direction a total distance of 974'± to a point, said point being on a property line of lands N/F of Love Creek MHP & Marina; thence continuing by and with said shore of Love Creek in a southwesterly and northeasterly direction respectively a distance of 53'± to a point, said point being the southernmost property corner of lands N/F of Brabara S. Atallian Trustee; thence continuing with said north shore of Love Creek in a generally northwesterly direction a distance of 240'± to a point, said point being on the southwesterly property line of lands N/F of said MHP and Marina; thence proceeding by and with said Marina lands in a northwesterly, northeasterly, southeasterly, northeasterly, northwesterly, southwesterly, northwesterly direction respectively a total distance of 806'± to a point, said point being a property corner of lands N/F of Love Creek MHP & Marina, said point also being on the southerly ROW of John J. Williams Highway (Rt. 24); thence crossing Love Creek in a southwesterly direction a distance of 103'± to a point, said point being on the southwesterly shore of Love Creek, said point also being on the SCUSSD boundary; thence proceeding by and with said SCUSSD boundary and Love Creek shoreline in a northwesterly direction a distance of 74'± to a point, said point being the place of Beginning.

NOTE: The above descriptions have been prepared using Sussex County Tax Map 334-18.00 and Sussex County property assessment records. The annexation contains 36.94 acres more or less.

A map outlining and describing the extension of the SCUSSD is attached. The area involved is crosshatched and highlighted.

BE IT FURTHER RESOLVED that the Sussex County Council directs the County Engineer and the Attorney for the County Council to procure the necessary lands and right-of-way by purchase, agreement, or condemnation in accordance with the existing statutes; and

BE IT FURTHER RESOLVED that the County Engineer is hereby authorized to prepare maps, plans, specifications, and estimates, let contracts for and supervise the construction and maintenance of, or enlarging and remodeling of, any and all structures required to provide for the safe disposal of sewage in the sanitary sewer district, as amended.

I DO HEREBY CERTIFY THAT THE FOREGOING IS A TRUE AND CORRECT COPY OF RESOLUTION NO. R 002 25 ADOPTED BY THE SUSSEX COUNTY COUNCIL ON THE 4TH DAY OF FEBRUARY 2025.



Tracy N. Torbert
Clerk of the Council

PROPOSED ANNEXATION Love Creek MHC

Existing SSD Area of Interest



0 80 160 320 Feet
Map created: 2/5/2025

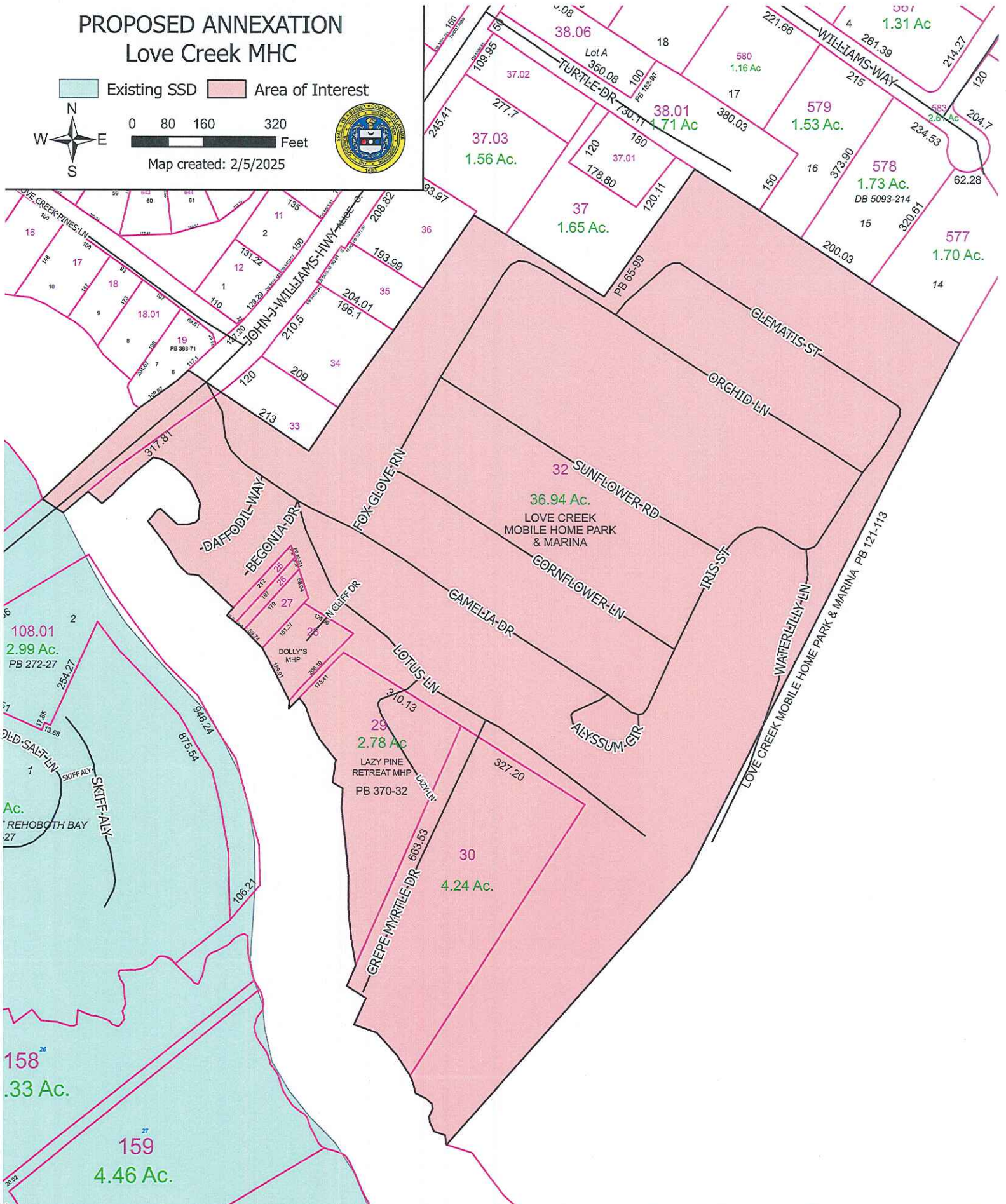

The proposed annexation is scheduled to be discussed February 4, 2025 at 1:30 PM
in the Sussex County Council Chambers
For more information please visit: <https://sussexcountyde.gov/proposed-projects-schedules>
Or call Sussex County Utility Planning at 302-855-7370