

RESOLUTION NO. R 007 25

A RESOLUTION TO EXTEND THE BOUNDARY OF THE SUSSEX COUNTY UNIFIED SANITARY SEWER DISTRICT (SCUSSD) NORTH MILLVILLE AREA, TO INCLUDE 134-11.00-141.00. LOCATED ON THE WEST SIDE OF HICKORY MANOR ROAD IN BALTIMORE HUNDRED, SUSSEX COUNTY, DELAWARE AND RECORDED IN THE OFFICE OF THE RECORDER OF DEEDS, IN AND FOR SUSSEX COUNTY, DELAWARE.

WHEREAS, Sussex County has established the Sussex County Unified Sanitary Sewer Sanitary Sewer District (SCUSSD); and

WHEREAS, in the best interests of the present district and to enhance the general health and welfare of that portion of Sussex County in the vicinity of Hickory Manor Road, the inclusion of this area will be beneficial; and

WHEREAS, in accordance with 9 Del.C., Section 6502 (a), the Sussex County Council may, upon request of the County Engineer, revise the boundary of an established sewer district when 50 or more houses have been connected by posting a public notice in four public places in the district describing the new or revised boundary; and

WHEREAS, the Sussex County Council has caused to be posted a public notice in at least four public places in the district, as verified by the affidavit of Phillip C. Calio, a copy of which affidavit and public notice is attached hereto and made a part hereof; and

WHEREAS, in accordance with 9 Del.C., Section 6502 (b), the Sussex County Council shall, within ninety days after posting the public notices pass a formal resolution establishing the new boundary of the district;

NOW, THEREFORE, BE IT RESOLVED the Sussex County Council hereby revises the boundary of the SCUSSD to encompass the lands mentioned above in the area and further described as follows:

Beginning at a point, said point being on the SCUSSD boundary, said point also being the northeasternmost property corner of lands Now-or-Formerly (N/F) of Salt Air Properties, LLC, said point further being on the southerly ROW of Hickory Manor Road; thence proceeding by and with said SCUSSD boundary and ROW in a southwesterly direction a distance of 320'± to a point; thence leaving said SCUSSD boundary and ROW and proceeding in a northwesterly direction across Hickory Manor Road a distance of 50'± to a point, said point being on the northerly ROW of Hickory Manor Road, said point also being a property corner of lands N/F of Louis J. Travalini Sr. TTEE REV TR; thence leaving said ROW and proceeding by and with said Travalini lands in a northwesterly, southwesterly, northerly, northwesterly, and northeasterly respectively a total distance of 912'± to a point, said point being on the southerly ROW of Vines Creek Road (Rt. 26); thence continuing with said ROW and Travalini lands in a southeasterly direction a distance of 256.85'± to a point, said point being on the westerly ROW of Hickory Manor Road, said point also being on the southerly ROW of Vines Creek Road; thence leaving said ROW of Hickory Manor Road and proceeding across Hickory Manor Road a distance of 50'± to a point, said point being that of the BEGINNING.

NOTE: The above descriptions have been prepared using Sussex County Tax Map 134-11.00 and Sussex County property assessment records. The annexation contains 2.87 acres more or less.

A map outlining and describing the extension of the SCUSSD is attached. The area involved is crosshatched and highlighted.

BE IT FURTHER RESOLVED that the Sussex County Council directs the County Engineer and the Attorney for the County Council to procure the necessary lands and right-of-way by purchase, agreement, or condemnation in accordance with the existing statutes; and

BE IT FURTHER RESOLVED that the County Engineer is hereby authorized to prepare maps, plans, specifications, and estimates, let contracts for and supervise the construction and maintenance of, or enlarging and remodeling of, any and all structures required to provide for the safe disposal of sewage in the sanitary sewer district, as amended.

I DO HEREBY CERTIFY THAT THE FOREGOING IS A TRUE AND CORRECT COPY OF RESOLUTION NO. R 007 25 ADOPTED BY THE SUSSEX COUNTY COUNCIL ON THE 4TH DAY OF MARCH 2025.



Tracy N. Torbert
Clerk of the Council

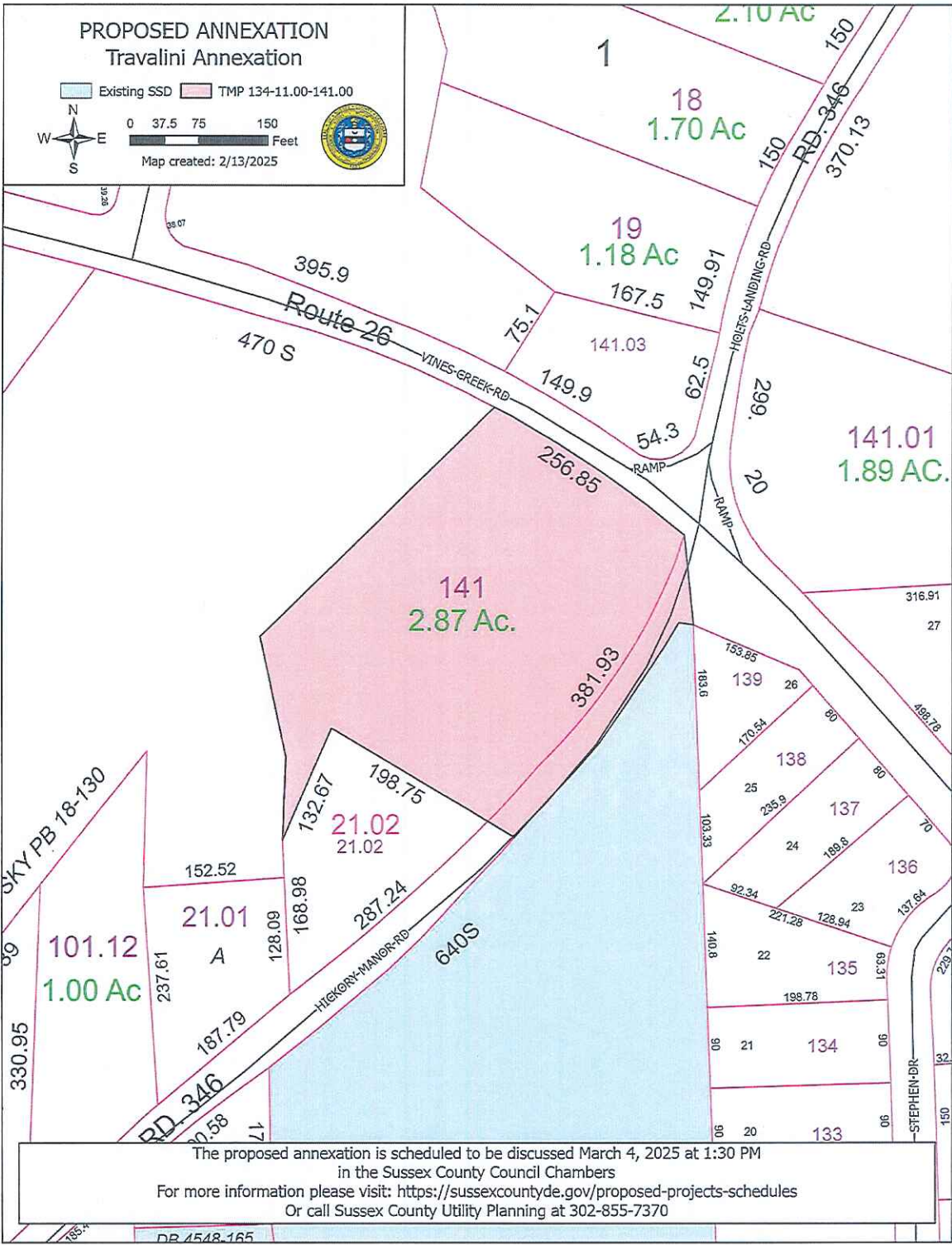

The proposed annexation is scheduled to be discussed March 4, 2025 at 1:30 PM
 in the Sussex County Council Chambers
 For more information please visit: <https://sussexcountype.gov/proposed-projects-schedules>
 Or call Sussex County Utility Planning at 302-855-7370