

RESOLUTION NO. R 009 25

A RESOLUTION TO EXTEND THE BOUNDARY OF THE SUSSEX COUNTY UNIFIED SANITARY SEWER DISTRICT (SCUSSD) MILLER CREEK AREA, TO INCLUDE THE CAMP SALTY FARM ON THE SOUTH SIDE CAMP BARNES ROAD LOCATED IN THE BALTIMORE HUNDRED, SUSSEX COUNTY, DELAWARE AND RECORDED IN THE OFFICE OF THE RECORDER OF DEEDS, IN AND FOR SUSSEX COUNTY, DELAWARE.

WHEREAS, Sussex County has established the Sussex County Unified Sanitary Sewer Sanitary Sewer District (SCUSSD); and

WHEREAS, in the best interests of the present district and to enhance the general health and welfare of that portion of Sussex County in the vicinity of the Bayard area, the inclusion of this area will be beneficial; and

WHEREAS, in accordance with 9 Del.C., Section 6502 (a), the Sussex County Council may, upon request of the County Engineer, revise the boundary of an established sewer district when 50 or more houses have been connected by posting a public notice in four public places in the district describing the new or revised boundary; and

WHEREAS, the Sussex County Council has caused to be posted a public notice in at least four public places in the district, as verified by the affidavit of Phillip C. Calio, a copy of which affidavit and public notice is attached hereto and made a part hereof; and

WHEREAS, in accordance with 9 Del.C., Section 6502 (b), the Sussex County Council shall, within ninety days after posting the public notices pass a formal resolution establishing the new boundary of the district;

NOW, THEREFORE, BE IT RESOLVED the Sussex County Council hereby revises the boundary of the SCUSSD to encompass the lands mentioned above in the Miller Creek area and further described as follows:

Beginning at a point, said point being on the SCUSSD (Miller Creek Area) boundary, said point also being on the northerly Right-Of-Way (ROW) of Camp Barnes Road, approximately 521'± northwest of the intersection with Millers Neck Road; thence proceeding by and with said sewer district boundary and said ROW in a southeasterly direction a distance of 206'± to a point, said point being on the northerly ROW of Camp Barnes Road, said point also being in the southernmost property corner Now-or-Formerly (N/F) of James & Kimberly Raimo; thence leaving said SCUSSD boundary and northerly ROW and proceeding in a southerly direction across Camp Barnes Road a distance of 50'± to a point, said point being on the southerly ROW of Camp Barnes Road, said point also being on the northerly property line of lands N/F of Camp Salty Farm LLC; thence proceeding by and with said Salty Farm lands in a southeasterly, southwesterly, northwesterly & northeasterly directions respectively a total distance of 1975'± to a point, said point being on the southerly ROW of Camp Barnes Road; thence proceeding in a northwesterly direction across Camp Barnes Road a distance of 50'± to a point, said point being that of the BEGINNING.

NOTE: The above description has been prepared using Sussex County Tax Map 134-19.00 and Sussex County property assessment records. The annexation contains 5.15 acres more or less.

A map outlining and describing the extension of the SCUSSD is attached. The area involved is crosshatched.

BE IT FURTHER RESOLVED that the Sussex County Council directs the County Engineer and the Attorney for the County Council to procure the necessary lands and right-of-way by purchase, agreement, or condemnation in accordance with the existing statutes; and

BE IT FURTHER RESOLVED that the County Engineer is hereby authorized to prepare maps, plans, specifications, and estimates, let contracts for and supervise the construction and maintenance of, or enlarging and remodeling of, any and all structures required to provide for the safe disposal of sewage in the sanitary sewer district, as amended.

I DO HEREBY CERTIFY THAT THE FOREGOING IS A TRUE AND CORRECT COPY OF RESOLUTION NO. R 009 25 ADOPTED BY THE SUSSEX COUNTY COUNCIL ON THE 25<sup>TH</sup> DAY OF MARCH 2025.



---

Tracy N. Torbert  
Clerk of the Council

**PROPOSED ANNEXATION**  
**Bridgeville Warehouses**

Existing SSD    TMP 131-19.00-4.00 & 5.00



0 62.5 125 250 Feet  
 Map created: 2/21/2025

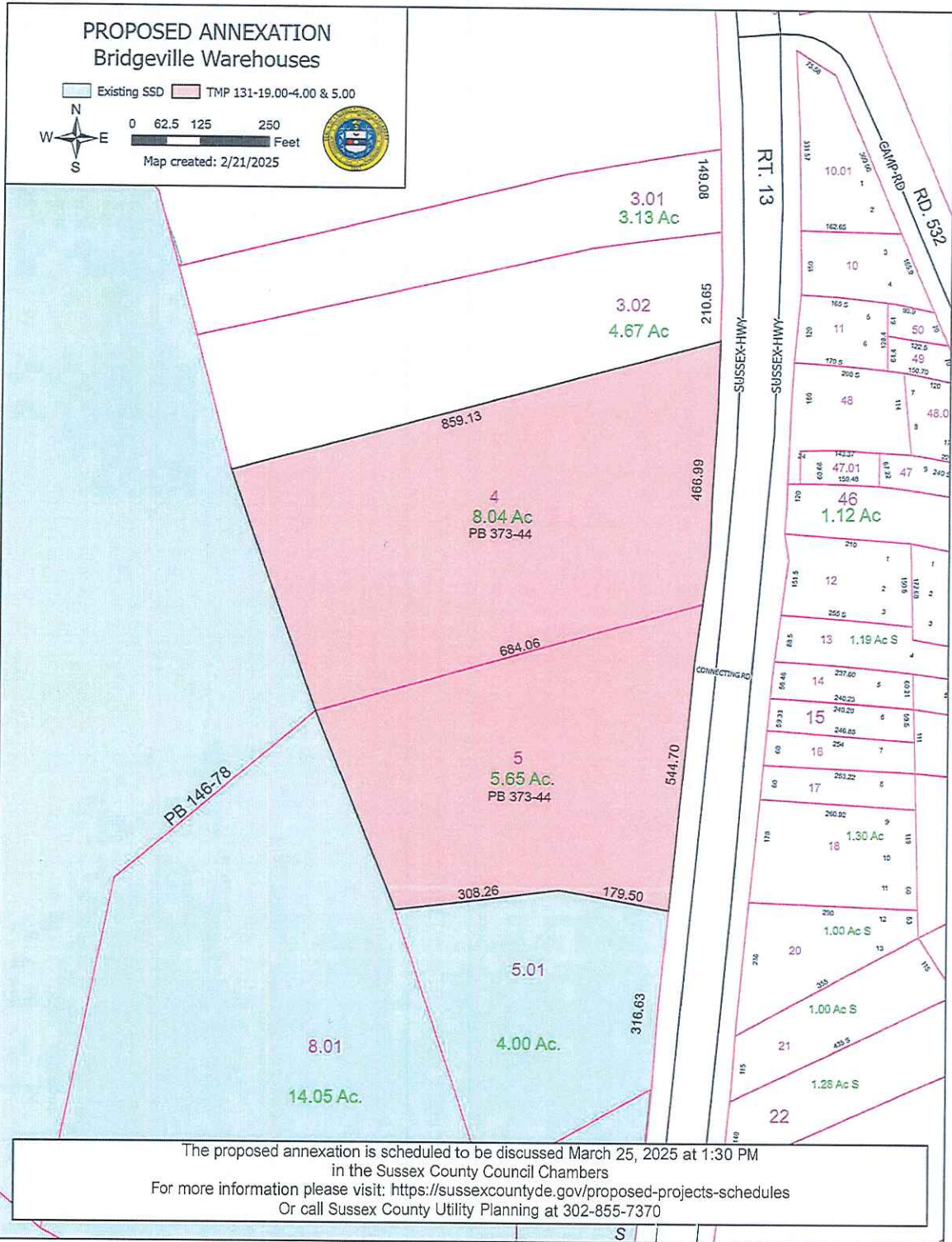

The proposed annexation is scheduled to be discussed March 25, 2025 at 1:30 PM  
 in the Sussex County Council Chambers  
 For more information please visit: <https://sussexcountyde.gov/proposed-projects-schedules>  
 Or call Sussex County Utility Planning at 302-855-7370