

**RESOLUTION NO. 010 23**

**A RESOLUTION TO EXTEND THE BOUNDARY OF THE SUSSEX COUNTY UNIFIED SANITARY SEWER DISTRICT (SCUSSD), TO INCLUDE EIGHT PARCELS ON THE SOUTHEAST SIDE OF JOHN J. WILLIAMS HWY. THE PARCELS ARE LOCATED IN THE LEWES & REHOBOTH HUNDRED, SUSSEX COUNTY, DELAWARE AND RECORDED IN THE OFFICE OF THE RECORDER OF DEEDS, IN AND FOR SUSSEX COUNTY, DELAWARE.**

**WHEREAS, Sussex County has established the Sussex County Unified Sanitary Sewer Sanitary Sewer District (SCUSSD); and**

**WHEREAS, in the best interests of the present district and to enhance the general health and welfare of that portion of Sussex County in the vicinity of John J. Williams Hwy., the inclusion of this area will be beneficial; and**

**WHEREAS, in accordance with 9 Del.C., Section 6502 (a), the Sussex County Council may, upon request of the County Engineer, revise the boundary of an established sewer district when 50 or more houses have been connected by posting a public notice in four public places in the district describing the new or revised boundary; and**

**WHEREAS, the Sussex County Council has caused to be posted a public notice in at least four public places in the district, as verified by the affidavit of Phillip C. Calio, a copy of which affidavit and public notice is attached hereto and made a part hereof; and**

**WHEREAS, in accordance with 9 Del.C., Section 6502 (b), the Sussex County Council shall, within ninety days after posting the public notices pass a formal resolution establishing the new boundary of the district;**

**NOW, THEREFORE, BE IT RESOLVED the Sussex County Council hereby revises the boundary of the SCUSSD to encompass the lands mentioned above situated on the north side of New Road, as follows:**

**Beginning at a point, said point being the northwesternmost property corner of lands Now or Formerly (N/F) of J. G. Townsend, Jr. Co., said point also being on the SCUSSD boundary, said point further being on the easterly Right-of-Way (ROW) of the intersection of John J. Williams Highway (Rt. 24) and Mulberry Knoll Road (SCR 284); thence proceeding by and with said Townsend lands, sewer boundary and ROW in a generally southerly direction a distance of 660'± to a point, said point being on the easterly ROW of Mulberry Knoll Road (SCR 284); thence proceeding in a northwesterly direction a distance of 55'± to a point, said point being on the westerly ROW of Mulberry Knoll Road (SCR 284), said point also being on the northeasterly property corner of lands N/F on Ralk Properties, LLC, said point also being the southeastern property corner of lands N/F of V&M, LLC; thence proceeding by and with said Ralk lands in a northwesterly and southwesterly direction respectively a distance of 264.35' to a point, said point being on the northeasterly property line of lands N/F of Cape Henlopen School District, said point also being a property corner of other lands of V&M, LLC; thence proceeding by and with said V&M, LLC lands in a northwesterly and northeasterly direction respectively a total distance of 751.14' to a point, said point being on the southeasterly ROW of John J. Williams Highway (Rt. 24); thence proceeding in a northeasterly direction crossing Mulberry Knoll Road (SCR 284) a distance of 60'± to a point, said point being that of the Beginning.**

**NOTE: The above description has been prepared using Sussex County Tax Map 334-12.00 and Sussex County property assessment records.**

**A map outlining and describing the extension of the SCUSSD is attached. The area involved is crosshatched.**

**BE IT FURTHER RESOLVED that the Sussex County Council directs the County Engineer and the Attorney for the County Council to procure the necessary lands and right-of-way by purchase, agreement, or condemnation in accordance with the existing statutes; and**

**BE IT FURTHER RESOLVED** that the County Engineer is hereby authorized to prepare maps, plans, specifications, and estimates, let contracts for and supervise the construction and maintenance of, or enlarging and remodeling of, any and all structures required to provide for the safe disposal of sewage in the sanitary sewer district, as amended.

**I DO HEREBY CERTIFY THAT THE FOREGOING IS A TRUE AND CORRECT COPY OF RESOLUTION NO. R 010 23 ADOPTED BY THE SUSSEX COUNTY COUNCIL ON THE 18<sup>TH</sup> DAY OF APRIL 2023.**

---

**Tracy N. Torbert**  
**Clerk of the Council**

# Proposed Annexation Mulberry Knoll Store

Existing SSD    Parcels of Interest

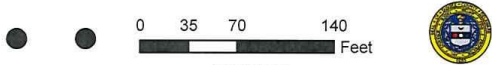

3/2/2023

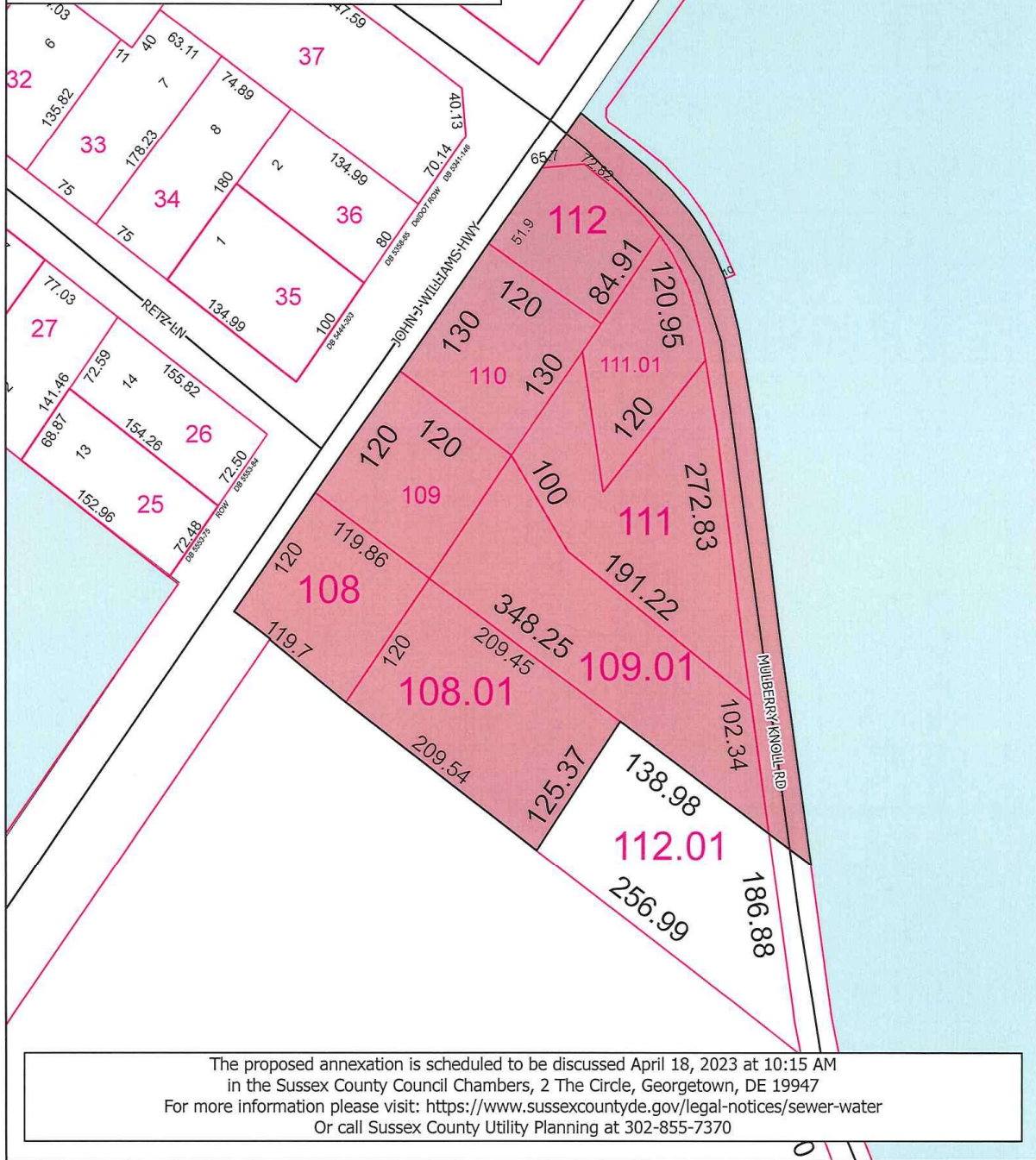

The proposed annexation is scheduled to be discussed April 18, 2023 at 10:15 AM  
in the Sussex County Council Chambers, 2 The Circle, Georgetown, DE 19947  
For more information please visit: <https://www.sussexcountyde.gov/legal-notices/sewer-water>  
Or call Sussex County Utility Planning at 302-855-7370