

RESOLUTION NO. R 010 24

A RESOLUTION ESTABLISHING A DATE, TIME, PLACE AND JUDGE FOR AN ELECTION TO BE HELD TO CONSIDER THE SUGAR MAPLE FARMS CHAPTER 96 SUSSEX COMMUNITY IMPROVEMENT PROJECT

WHEREAS, Chapter 96 of the Sussex County Code, Sussex Community Improvements, provides for a Sussex County Program to facilitate the improvements of streets, roadways, and other community amenities designated by the County Engineer that will, upon completion, benefit or serve the entire community and which are controlled by a private subdivision Property Owners Association, to be implemented by the Sussex County Engineering Department; and

WHEREAS, the subdivision known as Sugar Maple Farms, as represented on Sussex County Tax Map 330-16.00 Parcels 20 thru 85, and on Recorder of Deeds Plot Book 80 - Page 148; located off Coastal Highway (SR 1), south of Milford, DE, within the Cedar Creek Hundred, requested petition forms be provided from the Sussex County Engineering Department to determine if there was adequate interest in their community to obtain an estimate of costs and charges for proposed improvements, and if so, to submit the question of establishing a Chapter 96 Sussex Community Improvement project for the community of Sugar Maple Farms to an election, in accordance with the provisions of Sussex County Code, Chapter 96, Sussex Community Improvements; and

WHEREAS, it was determined by the Sussex County Engineering Department that Sugar Maple Farms meets all criteria as defined by Sussex County Code Chapter 96 and thereby provided by direct mail the requested petition form to each property owner of record within Sugar Maple Farms on January 3, 2024 in accordance with the Sussex County Code, along with a project boundary map and project preliminary cost estimate, with estimated charges to each property owner; and

WHEREAS, thirty-five (35) valid petition forms were returned to Sussex County Engineering Department and verified to represent approximately fifty-three percent (53%) of the sixty-six (66) assessable properties in the proposed project, thereby exceeding the fifty percent (50%) or more representation requirement in § 96-5 of the Sussex County Code; and

WHEREAS, on March 20, 2024, the Sussex County Engineering Department mailed to all Sugar Maple Farms property owners of record within the proposed project area a Notice of a Public Meeting to be held at the Slaughter Beach Fire Hall in Slaughter Beach on April 18, 2024; as required by §96-5 of the Sussex County Code; and

WHEREAS, Sussex County Engineering Department held the Public Meeting on April 18, 2024 to discuss the Chapter 96 community improvements proposal and receive comments, at the Slaughter Beach Fire Hall with Sugar Maple Farms property owners, affirming the project boundary and estimated charges to each property owner in accordance with Sussex County Code.

NOW, THEREFORE, BE IT RESOLVED, Sussex County Council hereby formally accepts the community of Sugar Maple Farms into the Sussex County Chapter 96 Sussex Community Improvement Program; and

BE IT FURTHER RESOLVED, that Sussex County Council approves for Sugar Maple Farms proposed Chapter 96 Sussex Community Improvement project, an estimated annual billing rate of \$822.00 for a ten (10) year time period, or an estimated lump sum payment cost of \$5,910.00 for each assessable property located within the boundary of the Sugar Maple Farms proposed Chapter 96 project, as determined by the Sussex County Engineering and Finance Departments; and

BE IT FURTHER RESOLVED, that Sussex County Council does establish Thursday July 11, 2024 from 10 am to 4 pm., on the third floor of the Sussex County Administration Building located at 2 The Circle, Georgetown, DE 19947, as the date, time, and place for the Election to determine whether the property owners of Sugar Maple Farms are in favor of proceeding with improvements under the proposed Chapter 96 Project, as presented at the April 18, 2024 Public Meeting. A provision for Absentee Ballots shall also be provided as part of the Election process; and

BE IT FURTHER RESOLVED, that Sussex County Council appoints J. Mark Parker, P.E., of the Sussex County Engineering Department, or his designee, to be the judge of said official Election; and

BE IT FURTHER RESOLVED, that Sussex County Council directs the Sussex County Engineering Department to provide notice to all assessable property owners of record in the Sugar Maple Farms proposed Chapter 96 Project, of the date, time, and place of the Election, including estimated costs and charges to property owners, as required by §96-5 of the Sussex County Code, and to provide proper notification of any necessary changes to date, time and location of the Election.

I DO HEREBY CERTIFY THAT THE FOREGOING IS A TRUE AND CORRECT COPY OF RESOLUTION NO. R 010 24 ADOPTED BY THE SUSSEX COUNTY COUNCIL ON THE 4TH DAY OF JUNE 2024.



Tracy N. Torbert
Clerk of the Council

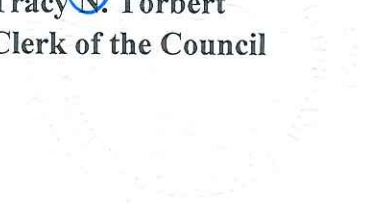

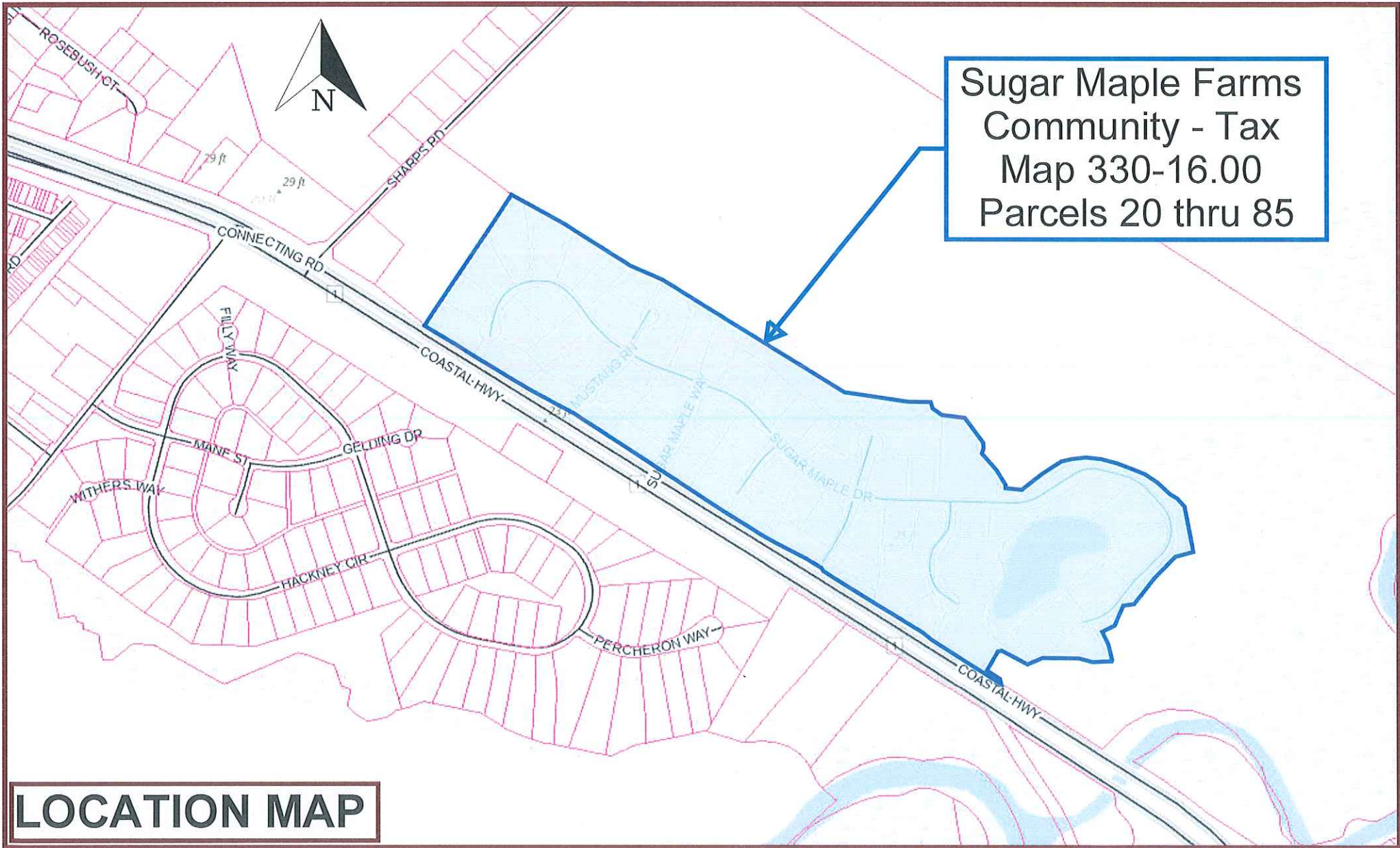

Sugar Maple Farms
Community - Tax
Map 330-16.00
Parcels 20 thru 85

LOCATION MAP