

RESOLUTION NO R. 010 25

A RESOLUTION TO EXTEND THE BOUNDARY OF THE SUSSEX COUNTY UNIFIED SANITARY SEWER DISTRICT (SCUSSD), TO INCLUDE THE BRIDGEVILLE WAREHOUSES ON THE WEST SIDE OF SUSSEX HIGHWAY. THE PARCEL IS LOCATED IN THE NORTHWEST FORK HUNDRED, SUSSEX COUNTY, DELAWARE AND RECORDED IN THE OFFICE OF THE RECORDER OF DEEDS, IN AND FOR SUSSEX COUNTY, DELAWARE.

WHEREAS, Sussex County has established the Sussex County Unified Sanitary Sewer Sanitary Sewer District (SCUSSD); and

WHEREAS, in the best interests of the present district and to enhance the general health and welfare of that portion of Sussex County in the vicinity of Sussex Highway (Rt. 13), the inclusion of this area will be beneficial; and

WHEREAS, in accordance with 9 Del.C., Section 6502 (a), the Sussex County Council may, upon request of the County Engineer, revise the boundary of an established sewer district when 50 or more houses have been connected by posting a public notice in four public places in the district describing the new or revised boundary; and

WHEREAS, the Sussex County Council has caused to be posted a public notice in at least four public places in the district, as verified by the affidavit of Phillip C. Calio, a copy of which affidavit and public notice is attached hereto and made a part hereof; and

WHEREAS, in accordance with 9 Del.C., Section 6502 (b), the Sussex County Council shall, within ninety days after posting the public notices pass a formal resolution establishing the new boundary of the district;

NOW, THEREFORE,

BE IT RESOLVED the Sussex County Council hereby revises the boundary of the SCUSSD to encompass the lands mentioned above situated on the west side of Sussex Highway, south of the Town of Bridgeville, as follows:

Beginning at a point, said point being on the westerly Right-of-Way (ROW) of Sussex Highway (Rt. 13), said point also being on the SCUSSD boundary, said point further being a shared property corner of lands Now-or-Formerly (N/F) of FDPN Management LLC and lands N/F of Joe Johnson, thence proceeding by and with said FDPN lands and SCUSSD boundary in a northwesterly, southwesterly and northwesterly direction respectively a distance of 1,347'± to a point, said point being a shared property corner of lands N/F of Jeffrey Lui, lands N/F of Cannon Road Farms Two, LLC and other lands of FDPN Management LLC; thence leaving said SCUSSD boundary and continuing with other lands of FDPN in a northeasterly direction of 860'± to a point, said point being on the westerly ROW of Sussex Highway (Rt. 13); thence proceeding by and with said ROW in a generally southerly direction a distance of 1,012'± to a point, said point being the place and point of Beginning.

NOTE: The above description has been prepared using Sussex County Tax Map 131-19.00 and Sussex County property assessment records. The annexation contains 13.69 acres more or less.

A map outlining and describing the extension of the SCUSSD is attached. The area involved is crosshatched.

BE IT FURTHER RESOLVED that the Sussex County Council directs the County Engineer and the Attorney for the County Council to procure the necessary lands and right-of-way by purchase, agreement, or condemnation in accordance with the existing statutes; and

BE IT FURTHER RESOLVED that the County Engineer is hereby authorized to prepare maps, plans, specifications, and estimates, let contracts for and supervise the construction and maintenance of, or enlarging and remodeling of, any and all structures required to provide for the safe disposal of sewage in the sanitary sewer district, as amended.

I DO HEREBY CERTIFY THAT THE FOREGOING IS A TRUE AND CORRECT COPY OF RESOLUTION NO. R 010 25 ADOPTED BY THE SUSSEX COUNTY COUNCIL ON THE 25TH DAY OF MARCH 2025.



Tracy N. Torbert
Clerk of the Council

PROPOSED ANNEXATION Bridgeville Warehouses

Existing SSD TMP 131-19.00-4.00 & 5.00



0 62.5 125 250 Feet
Map created: 2/21/2025

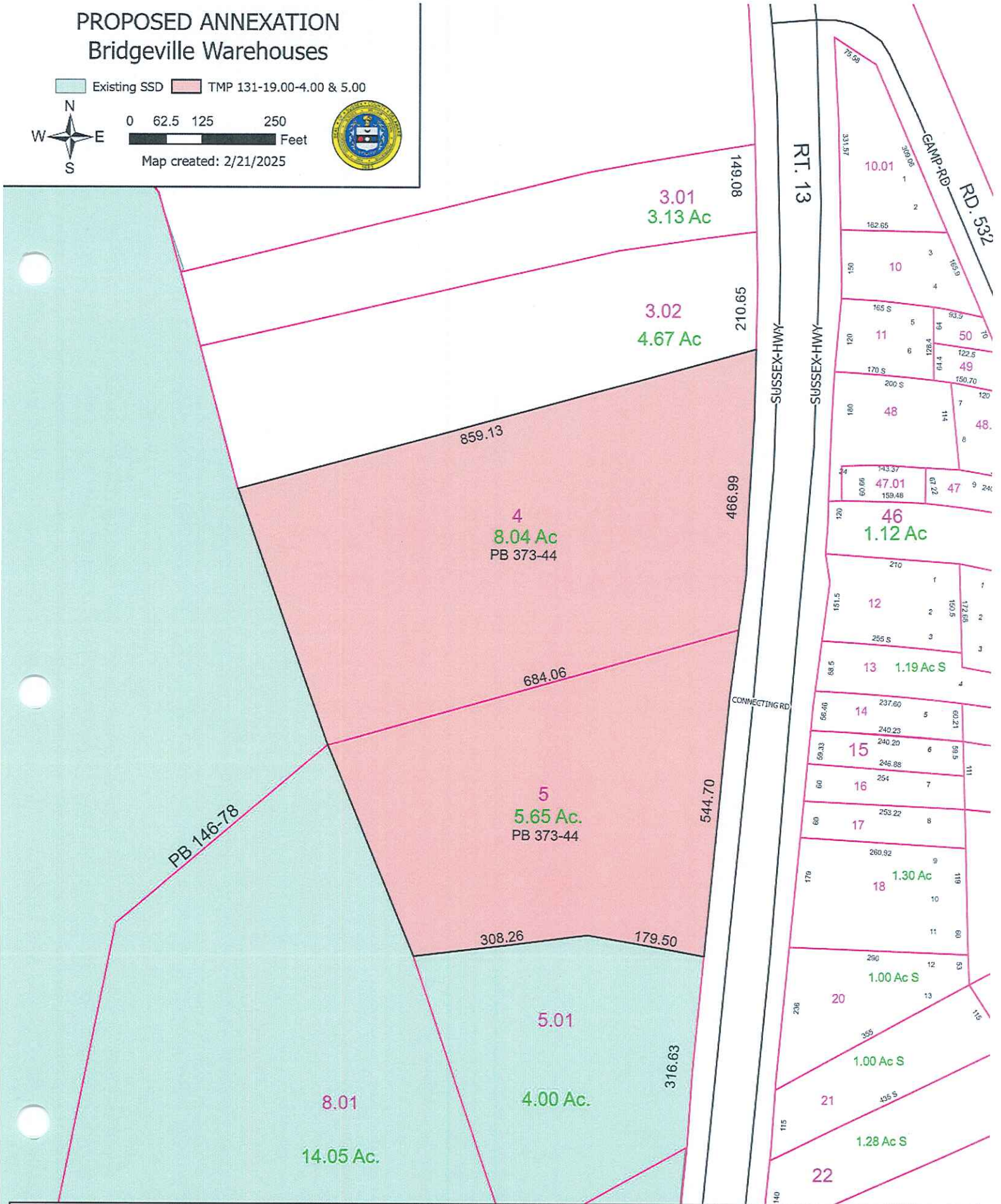

The proposed annexation is scheduled to be discussed March 25, 2025 at 1:30 PM
in the Sussex County Council Chambers
For more information please visit: <https://sussexcountyde.gov/proposed-projects-schedules>
Or call Sussex County Utility Planning at 302-855-7370