

**RESOLUTION NO. R 011 22**

A RESOLUTION TO EXTEND THE BOUNDARY OF THE SUSSEX COUNTY UNIFIED SANITARY SEWER DISTRICT (SCUSSD) ANGOLA NECK AREA, TO INCLUDE THE TERRAPIN ISLAND AREA, ON THE EAST SIDE OF CAMP ARROWHEAD ROAD LOCATED IN THE INDIAN RIVER HUNDRED, SUSSEX COUNTY, DELAWARE AND RECORDED IN THE OFFICE OF THE RECORDER OF DEEDS, IN AND FOR SUSSEX COUNTY, DELAWARE.

WHEREAS, Sussex County has established the Sussex County Unified Sanitary Sewer Sanitary Sewer District (SCUSSD); and

WHEREAS, in the best interests of the present district and to enhance the general health and welfare of that portion of Sussex County in the vicinity of Terrapin Island area, the inclusion of this area will be beneficial; and

WHEREAS, in accordance with 9 Del.C., Section 6502 (a), the Sussex County Council may, upon request of the County Engineer, revise the boundary of an established sewer district when 50 or more houses have been connected by posting a public notice in four public places in the district describing the new or revised boundary; and

WHEREAS, the Sussex County Council has caused to be posted a public notice in at least four public places in the district, as verified by the affidavit of Phillip C. Calio, a copy of which affidavit and public notice is attached hereto and made a part hereof; and

WHEREAS, in accordance with 9 Del.C., Section 6502 (b), the Sussex County Council shall, within ninety days after posting the public notices pass a formal resolution establishing the new boundary of the district;

NOW, THEREFORE,

BE IT RESOLVED the Sussex County Council hereby revises the boundary of the SCUSSD to encompass the lands mentioned above in the Terrapin Island area and further described as follows:

Beginning at a point, said point being on the westerly Right-of-Way (ROW) of Camp Arrowhead Rd., said point also being on the SCUSSD boundary, said point further being a property corner of lands Now-or-Formerly (N/F) of Woods on Herring Creek Homeowners Association (HOA); thence continuing with said ROW, SCUSSD boundary and HOA lands in a northwesterly direction a distance of 65'± to a point; thence leaving said ROW, SCUSSD boundary and HOA lands and proceeding across Camp Arrowhead Road in a northeasterly direction a distance of 50'± to a point, said point being on the easterly ROW of Camp Arrowhead Road and being a corner for parcel 234-18.00-31.00, lands N/F of EVG FT Ventures, LLC and the easterly ROW of Cove Court; thence leaving said ROW and proceeding by and with said EVG FT Ventures, LLC lands the following 14 courses and distances: (1) N04°06'28"W 438.07', (2) N85°18'25"E 2,025.92', (3) S28°17'37"E 362.77', (4) S06°16'57"E 297.01', (5) N84°45'33"E 358.51', (6) S12°57'08"E 110.66', (7) S64°04'54"W 197.36', (8) N82°10'15"W 480.15', (9) S16°53'55"W 12.68', (10) N89°05'58"W 1,598.59', (11) N21°21'11"W 3.12', (12) S86°22'39"W 15.09', (13) N22°46'56"W 88.81', (14) S75°46'29"W 211.54' to a point, said point being on the easterly ROW of Camp Arrowhead Road; thence leaving said ROW and crossing Camp Arrowhead Road in a westerly direction a distance of 50'± to a point, said point being that of the BEGINNING.

**NOTE: The above description has been prepared using Sussex County Tax Map 234-18.00 and Sussex County property assessment records. The annexation contains 30.08 acres more or less.**

**A map outlining and describing the extension of the SCUSSD is attached. The area involved is crosshatched and highlighted.**

**BE IT FURTHER RESOLVED that the Sussex County Council directs the County Engineer and the Attorney for the County Council to procure the necessary lands and right-of-way by purchase, agreement, or condemnation in accordance with the existing statutes; and**

**BE IT FURTHER RESOLVED that the County Engineer is hereby authorized to prepare maps, plans, specifications, and estimates, let contracts for and supervise the construction and maintenance of, or enlarging and remodeling of, any and all structures required to provide for the safe disposal of sewage in the sanitary sewer district, as amended.**

**I DO HEREBY CERTIFY THAT THE FOREGOING IS A TRUE AND CORRECT COPY OF RESOLUTION NO. R 011 22 ADOPTED BY THE SUSSEX COUNTY COUNCIL ON THE 25<sup>TH</sup> DAY OF OCTOBER 2022.**

---

**Tracy N. Torbert  
Clerk of the Council**



# **PUBLIC NOTICE**

## **PROPOSED TERRAPIN ISLAND EXPANSION OF THE SUSSEX COUNTY UNIFIED SANITARY SEWER DISTRICT (ANGOLA NECK AREA)**

**NOTICE IS HEREBY GIVEN** that the Sussex County Council voted on September 20, 2022 to consider extending the boundary of the Sussex County Unified Sanitary Sewer District (SCUSSD), Angola Area, to include a parcel of land along the east side of Camp Arrowhead Road, being situate in Indian River Hundred, Sussex County, Delaware.

This action is in conformity with 9 Del.C §6502.

A description of the area, which is contiguous to and to be added to the SCUSSD is described as follows:

**Beginning** at a point, said point being on the westerly Right-of-Way (ROW) of Camp Arrowhead Rd., said point also being on the SCUSSD boundary, said point further being a property corner of lands Now-or-Formerly (N/F) of Woods on Herring Creek Homeowners Association (HOA); thence continuing with said ROW, SCUSSD boundary and HOA lands in a northwesterly direction a distance of 65'± to a point; thence leaving said ROW, SCUSSD boundary and HOA lands and proceeding across Camp Arrowhead Road in a northeasterly direction a distance of 50'± to a point, said point being on the easterly ROW of Camp Arrowhead Road and being a corner for parcel 234-18.00-31.00, lands N/F of EVG FT Ventures, LLC and the easterly ROW of Cove Court; thence leaving said ROW and proceeding by and with said EVG FT Ventures, LLC lands the following 14 courses and distances: (1) N04°06'28"W 438.07', (2) N85°18'25"E 2,025.92', (3) S28°17'37"E 362.77', (4) S06°16'57"E 297.01', (5) N84°45'33"E 358.51', (6) S12°57'08"E 110.66', (7) S64°04'54"W 197.36', (8) N82°10'15"W 480.15', (9) S16°53'55"W 12.68', (10) N89°05'58"W 1,598.59', (11) N21°21'11"W 3.12', (12) S86°22'39"W 15.09', (13) N22°46'56"W 88.81', (14) S75°46'29"W 211.54' to a point, said point being on the easterly ROW of Camp Arrowhead Road; thence leaving said ROW and crossing Camp Arrowhead Road in a westerly direction a distance of 50'± to a point, said point being that of the **BEGINNING**.

NOTE: The above description has been prepared using Sussex County Tax Map 234-18.00 and Sussex County property assessment records. The annexation contains 32.13 acres

A map outlining and describing the extension of the SCUSSD is attached. The area involved is crosshatched and highlighted.

The public hearing will be held on this issue at 10:15 a.m. on October 25, 2022 in the Sussex County Council Chambers, County Administrative Offices, 2 The Circle, Georgetown, Delaware. All interested persons, officials, residents, voters, taxpayers, property owners, or corporations in any way affected by this boundary extension are welcome to attend. There will be an opportunity for questions and answers. The Sussex County Council following the hearing, at one of their regularly scheduled meetings, will make the final decision on the boundary extension.

For further information, please call or write the Sussex County Engineering Department, 2 The Circle, Post Office Box 589, Georgetown, DE 19947 – (302) 855-1299).

Hans M. Medlarz, P.E.  
County Engineer



SUSSEX COUNTY UNIFIED SANITARY SEWER DISTRICT  
TERRAPIN ISLAND EXPANSION  
AFFIDAVIT FOR PUBLIC HEARING

STATE OF DELAWARE )(

COUNTY OF SUSSEX )(

BE IT REMEMBERED, That the subscriber, PHILLIP C. CALIO, personally appeared before me and known to me personally to be such, who being by me duly sworn to law did depose and say as follows:

- A. On October 6, 2022 he was a Utility Planner for the Sussex County Engineering Department, Sussex County, State of Delaware; and
- B. On October 6, 2022 he did post the attached "Public Notice," prepared by the Sussex County Engineering Department, at the following locations:
1. On a post in front of a stop sign @ the intersection of Sand Bay Road and Camp Arrowhead Road,
  2. On a post in front of a stop sign @ the intersection of Woods Drive and Camp Arrowhead Road,
  3. On a post in front of a stop sign @ the intersection of Skyler Drive and Camp Arrowhead Road,
  4. On a post in front of stop sign @ the intersection of Angola Road and Camp Arrowhead Road,
  5. On the site of the annexation in the following 4 locations
    - a. On a post in the easterly ROW of Camp Arrowhead Road 121'± southeast of Cove Court,
    - b. On a post in the easterly ROW of Camp Arrowhead Road 144'± southeast of Cove Court,
    - c. On a post in the easterly ROW of Camp Arrowhead Road 163'± southeast of Cove Court,
    - d. On a post in the easterly ROW of Camp Arrowhead Road 190'± southeast of Cove Court.

  
PHILLIP C. CALIO

SWORN TO AND SUBSCRIBED before me on this 6<sup>th</sup> day of Oct. A.D., 2022

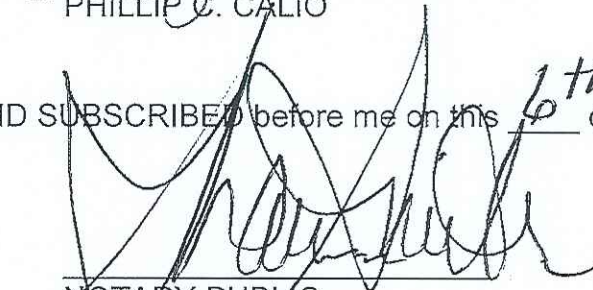
  
NOTARY PUBLIC



My Commission Expires 6/14/2024

Public Hearing  
Errapin Island  
TMP 234-18.00-31.00

105 210 420  
Feet



10/4/2022

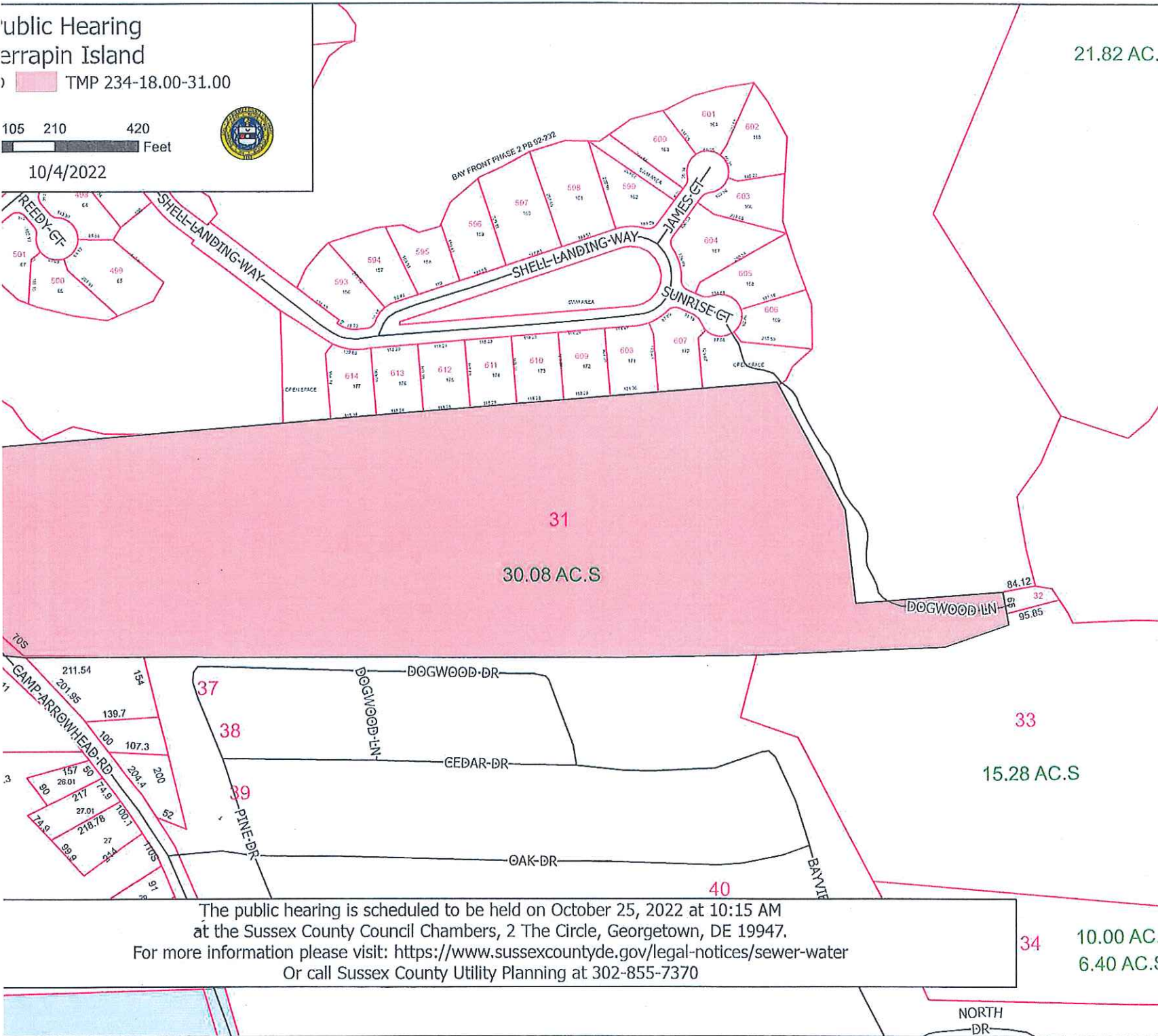

The public hearing is scheduled to be held on October 25, 2022 at 10:15 AM  
at the Sussex County Council Chambers, 2 The Circle, Georgetown, DE 19947.  
For more information please visit: <https://www.sussexcountyde.gov/legal-notice/sewer-water>  
Or call Sussex County Utility Planning at 302-855-7370