

RESOLUTION NO. R 013 23

A RESOLUTION TO EXTEND THE BOUNDARY OF THE SUSSEX COUNTY UNIFIED SANITARY SEWER DISTRICT (SCUSSD) ANGOLA NECK AREA, TO INCLUDE THE SUNCREST AREA, ON THE SOUTH SIDE OF CAMP ARROWHEAD ROAD AND THE SOUTH SIDE OF WATERVIEW ROAD LOCATED IN THE INDIAN RIVER HUNDRED, SUSSEX COUNTY, DELAWARE AND RECORDED IN THE OFFICE OF THE RECORDER OF DEEDS, IN AND FOR SUSSEX COUNTY, DELAWARE.

WHEREAS, Sussex County has established the Sussex County Unified Sanitary Sewer Sanitary Sewer District (SCUSSD); and

WHEREAS, in the best interests of the present district and to enhance the general health and welfare of that portion of Sussex County in the vicinity of Terrapin Island area, the inclusion of this area will be beneficial; and

WHEREAS, in accordance with 9 Del.C., Section 6502 (a), the Sussex County Council may, upon request of the County Engineer, revise the boundary of an established sewer district when 50 or more houses have been connected by posting a public notice in four public places in the district describing the new or revised boundary; and

WHEREAS, the Sussex County Council has caused to be posted a public notice in at least four public places in the district, as verified by the affidavit of Phillip C. Calio, a copy of which affidavit and public notice is attached hereto and made a part hereof; and

WHEREAS, in accordance with 9 Del.C., Section 6502 (b), the Sussex County Council shall, within ninety days after posting the public notices pass a formal resolution establishing the new boundary of the district;

NOW, THEREFORE, BE IT RESOLVED the Sussex County Council hereby revises the boundary of the SCUSSD to encompass the lands mentioned above in the Suncrest area and further described as follows:

Tract 1

Beginning at a point, said point being on the SCUSSD (Angola Neck Area) boundary, said point also being on the easterly property line of lands Now-or-Formerly (N/F) Marsh Farm, LLC; thence proceeding with the following 11 courses and distances (1) N11°34'24"W 769.87', (2) N74°36'58"E 750.04', (3) S15°24'58"E 300.00', (4) N69°31'25"E 410.89', (5) S02°26'30"W 203.49', (6) S41°22'19"W 854.24', (7) N34°49'18"W 39.14', (8) N41°40'44" E 116.27', (9) N85°25'33"W 210.70', (10) S76°07'29"W 124.25', (11) S69°23'36"W 197.02' to a point, said point being that of the BEGINNING.

Tract 2

Beginning at a point, said point being on the SCUSSD (Angola Neck area) boundary, said point also being on the easterly property line of other lands N/F of Marsh Farm, LLC; thence proceeding with the following 6 courses and distances, (1) N11°34'25"W 279.08', (2) N69°25'24"E 237.52', (3) on a curve to the right having a central angle of 20°23'03", a radius of 280.00', an arc length of 99.62', chord N79°36'56"E, a distance of 99.09', (4) N89°48'27"E 17.57' (5) a curve to the right having a central angle of 43°48'38", a radius

of 140.00', an arc length of 107.05', a chord S68°17'14"E, a distance of 104.46', (6) S48°23'16"W 506.21' to a point, said point being that of the BEGINNING

NOTE: The above description has been prepared using Sussex County Tax Map 234-12.00 and Sussex County property assessment records. The annexation contains 18.02 acres more or less.

A map outlining and describing the extension of the SCUSSD is attached. The area involved is crosshatched and highlighted.

BE IT FURTHER RESOLVED that the Sussex County Council directs the County Engineer and the Attorney for the County Council to procure the necessary lands and right-of-way by purchase, agreement, or condemnation in accordance with the existing statutes; and

BE IT FURTHER RESOLVED that the County Engineer is hereby authorized to prepare maps, plans, specifications, and estimates, let contracts for and supervise the construction and maintenance of, or enlarging and remodeling of, any and all structures required to provide for the safe disposal of sewage in the sanitary sewer district, as amended.

I DO HEREBY CERTIFY THAT THE FOREGOING IS A TRUE AND CORRECT COPY OF RESOLUTION NO. R 013 23 ADOPTED BY THE SUSSEX COUNTY COUNCIL ON THE 13TH DAY OF JUNE 2023.

Tracy N. Torbert
Clerk of the Council

Proposed Annexation Suncrest

Existing SSD TMP 234-12.00-22.31



5/3/2023

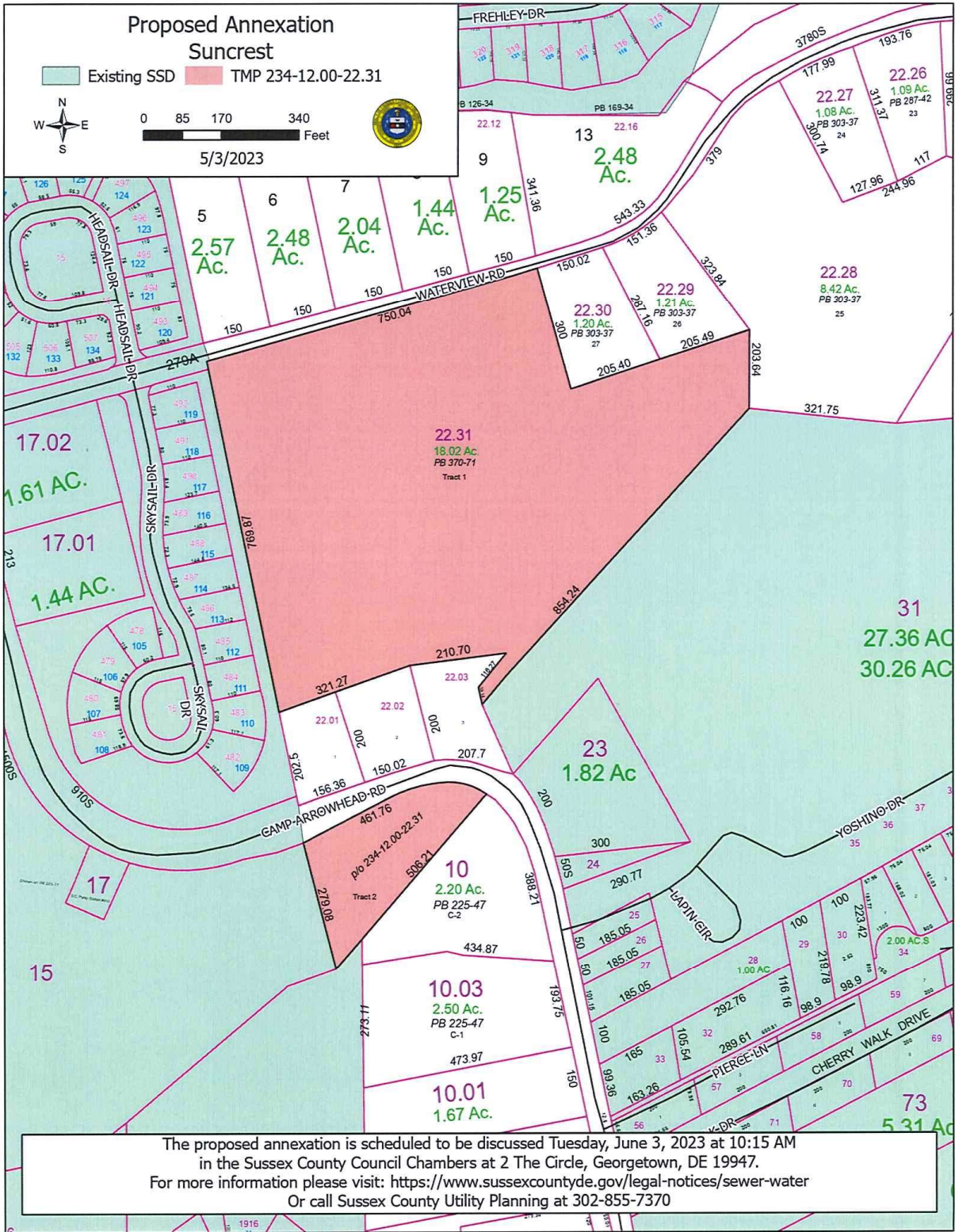

The proposed annexation is scheduled to be discussed Tuesday, June 3, 2023 at 10:15 AM in the Sussex County Council Chambers at 2 The Circle, Georgetown, DE 19947. For more information please visit: <https://www.sussexcountype.gov/legal-notice/sewer-water> Or call Sussex County Utility Planning at 302-855-7370