

RESOLUTION NO. R 014 23

A RESOLUTION TO EXTEND THE BOUNDARY OF THE SUSSEX COUNTY UNIFIED SANITARY SEWER DISTRICT (SCUSSD), TO INCLUDE ONE PARCEL ON THE WEST SIDE OF OLD LANDING ROAD. THE PARCEL IS LOCATED IN THE LEWES & REHOBOTH HUNDRED, SUSSEX COUNTY, DELAWARE AND RECORDED IN THE OFFICE OF THE RECORDER OF DEEDS, IN AND FOR SUSSEX COUNTY, DELAWARE.

WHEREAS, Sussex County has established the Sussex County Unified Sanitary Sewer Sanitary Sewer District (SCUSSD); and

WHEREAS, in the best interests of the present district and to enhance the general health and welfare of that portion of Sussex County in the vicinity of Old Landing Road, the inclusion of this area will be beneficial; and

WHEREAS, in accordance with 9 Del.C., Section 6502 (a), the Sussex County Council may, upon request of the County Engineer, revise the boundary of an established sewer district when 50 or more houses have been connected by posting a public notice in four public places in the district describing the new or revised boundary; and

WHEREAS, the Sussex County Council has caused to be posted a public notice in at least four public places in the district, as verified by the affidavit of Phillip C. Calio, a copy of which affidavit and public notice is attached hereto and made a part hereof; and

WHEREAS, in accordance with 9 Del.C., Section 6502 (b), the Sussex County Council shall, within ninety days after posting the public notices pass a formal resolution establishing the new boundary of the district.

NOW, THEREFORE, BE IT RESOLVED the Sussex County Council hereby revises the boundary of the SCUSSD to encompass the lands mentioned above situated on the west side of Old Landing Road, as follows:

Beginning at a point, said point being the southernmost property corner of lands Now-or-Formerly (N/F) of J.G. Townsend Jr. Co., said point also being on the westerly ROW of Old Landing Road (SCR 274), said point further being on the SCUSSD boundary; thence leaving said ROW and proceeding by and with said SCUSSD boundary in a northwesterly direction a distance of 257'± to a point; thence in a northeasterly direction a distance of 327'± to a point; thence a northwesterly direction 541'± to a point; thence in a northeasterly direction a distance of 104'± to a point; thence in a northeasterly direction a distance of 534'± to a point; thence in a southeasterly direction a distance of 256'± to a point; thence with a curve to the left with a radius of 903.50' and a curve distance of 329.02' to a point; thence in a southwesterly direction a distance of 300'± to a point, thence in a southwesterly direction a distance of 400'± to a point, said point being that of the BEGINNING

NOTE: The above description has been prepared using Sussex County Tax Map 334-12.00 and Sussex County property assessment records.

A map outlining and describing the extension of the SCUSSD is attached. The area involved is crosshatched.

BE IT FURTHER RESOLVED that the Sussex County Council directs the County Engineer and the Attorney for the County Council to procure the necessary lands and right-of-way by purchase, agreement, or condemnation in accordance with the existing statutes; and

BE IT FURTHER RESOLVED that the County Engineer is hereby authorized to prepare maps, plans, specifications, and estimates, let contracts for and supervise the construction and maintenance of, or enlarging and remodeling of, any and all structures required to provide for the safe disposal of sewage in the sanitary sewer district, as amended.

I DO HEREBY CERTIFY THAT THE FOREGOING IS A TRUE AND CORRECT COPY OF RESOLUTION NO. R 013 23 ADOPTED BY THE SUSSEX COUNTY COUNCIL ON THE 18TH DAY OF JULY 2023.

Tracy N. Torbert
Clerk of the Council

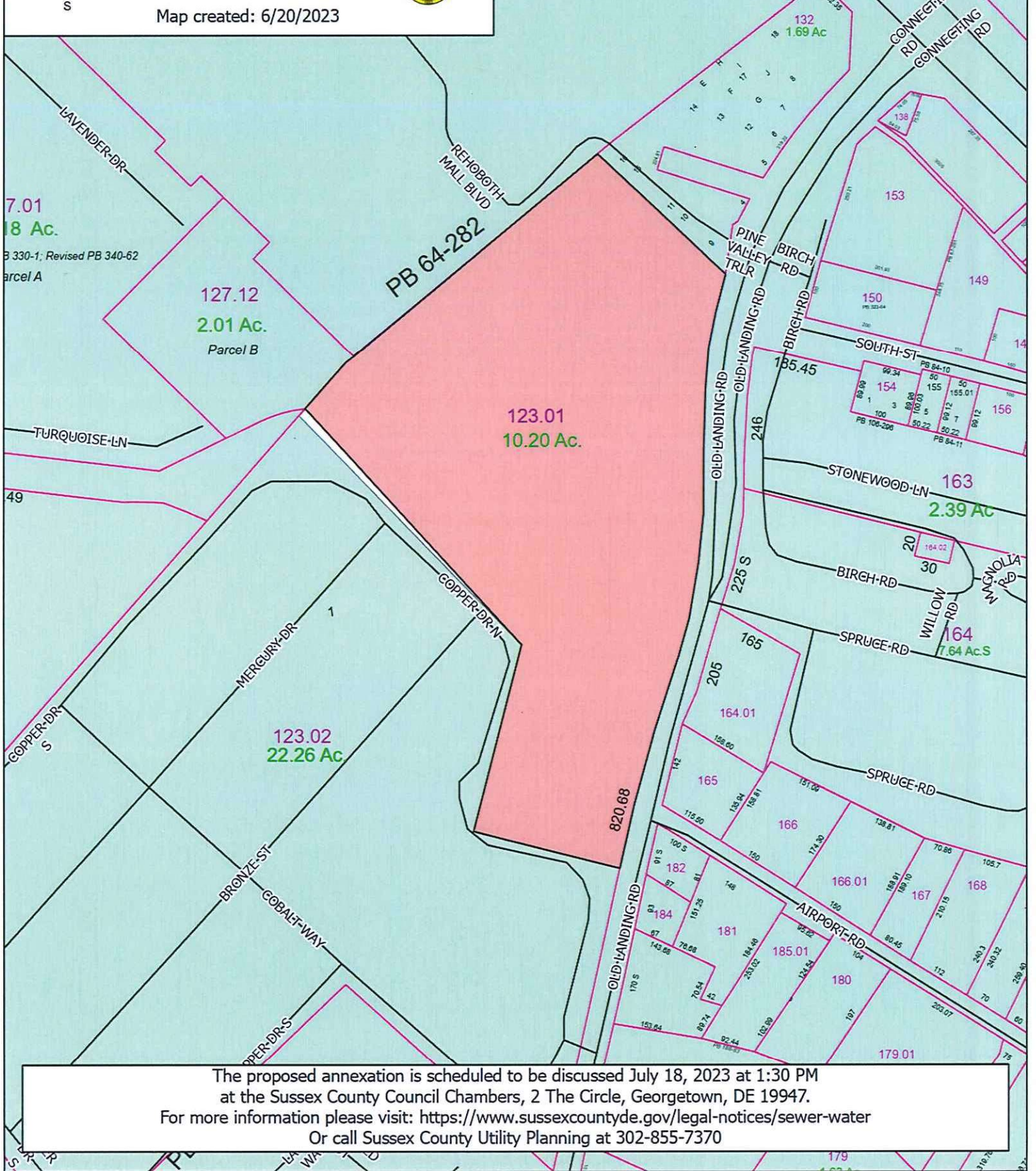

The proposed annexation is scheduled to be discussed July 18, 2023 at 1:30 PM at the Sussex County Council Chambers, 2 The Circle, Georgetown, DE 19947. For more information please visit: <https://www.sussexcountype.gov/legal-notice/ sewer-water> Or call Sussex County Utility Planning at 302-855-7370