

RESOLUTION NO. R 015 09

A RESOLUTION TO EXTEND THE BOUNDARY OF THE DAGSBORO-FRANKFORD SANITARY SEWER DISTRICT (DFSSD) TO INCLUDE A PARCEL OF LAND ALONG COUNTY ROAD 356 (HONOLULU ROAD), EAST OF THE TOWN OF FRANKFORD, AND BEING IN DAGSBORO HUNDRED, SUSSEX COUNTY, DELAWARE

WHEREAS, Sussex County has established the Dagsboro-Frankford Sanitary Sewer District; and

WHEREAS, in the best interests of the present district, and to enhance the general health and welfare of that portion of Sussex County east of the Town of Frankford, which includes a parcel of land along County Road 356, Honolulu Road, which is contiguous to the DFSSD, the inclusion of this property will be beneficial; and

WHEREAS, in accordance with 9 Del.C., Section 6502 (a), the Sussex County Council may, upon request of the County Engineer, revise the boundary of an established sewer district when 50 or more houses have been connected by posting a public notice in four public places in the district describing the new or revised boundary; and

WHEREAS, the Sussex County Council has caused to be posted a public notice in at least four public places in the district, as verified by the affidavit of Anthony DiGiuseppe, Jr., a copy of which affidavit and public notice is attached hereto and made a part hereof; and

WHEREAS, in accordance with 9 Del.C., Section 6502 (b), the Sussex County Council shall, within thirty days after posting the public notices pass a formal resolution establishing the new boundary of the district;

NOW, THEREFORE, BE IT RESOLVED the Sussex County Council hereby revises the boundary of the Dagsboro-Frankford Sanitary Sewer District to encompass a certain parcel of land situated along County Road 356, Honolulu Road, east of the Town of Frankford.

BEGINNING at a point situate on the centerline of County Road 356 (Honolulu Road), said point being ± 430.00 feet west of the intersection of the centerlines of County Road 356 and County Road 54 (Thatcher Street), said point also being a point on the DFSSD boundary; thence by and with said boundary in the following directions: northeasterly ± 182.30 feet, and northwesterly ± 78.35 feet to a point; said point being the

north westernmost corner of lands now or formally (N/F) of Clarence E. & Frances Custis; thence by and with said lands of Custis ± 170.50 feet in a southwesterly direction to a point, said point being the south westernmost corner of said lands and a point on the northern ROW of Honolulu Road, thence continuing in a southwesterly direction ± 25 feet to the centerline of roadway; thence by and with said centerline of roadway in a southeasterly direction ± 80 to a point, said point being that of the beginning.

BE IT FURTHER RESOLVED that the Sussex County Council directs the County Engineer and a County Attorney or Assistant County Attorney for the County Council to procure the necessary lands and rights-of-way by purchase, agreement, or condemnation in accordance with the existing statutes;

BE IT FURTHER RESOLVED that the County Engineer is hereby directed to prepare maps, plans, specifications, and estimates, let contracts for and supervise the construction and maintenance of, or enlarging and remodeling of, any and all structures required to provide for the safe disposal of sewage in the sanitary sewer district, as amended.

I DO HEREBY CERTIFY THAT THE FOREGOING IS A TRUE AND CORRECT COPY OF RESOLUTION NO. R 015 09 ADOPTED BY THE SUSSEX COUNTY COUNCIL ON THE 2ND DAY OF JUNE 2009.



ROBIN A. GRIFFITH
CLERK OF THE COUNCIL

PROPOSED EXPANSION OF THE DAGSBORO
FRANKFORD SANITARY SEWER DISTRICT
(CUSTIS REQUEST)

AREA IS CROSSHATCHED

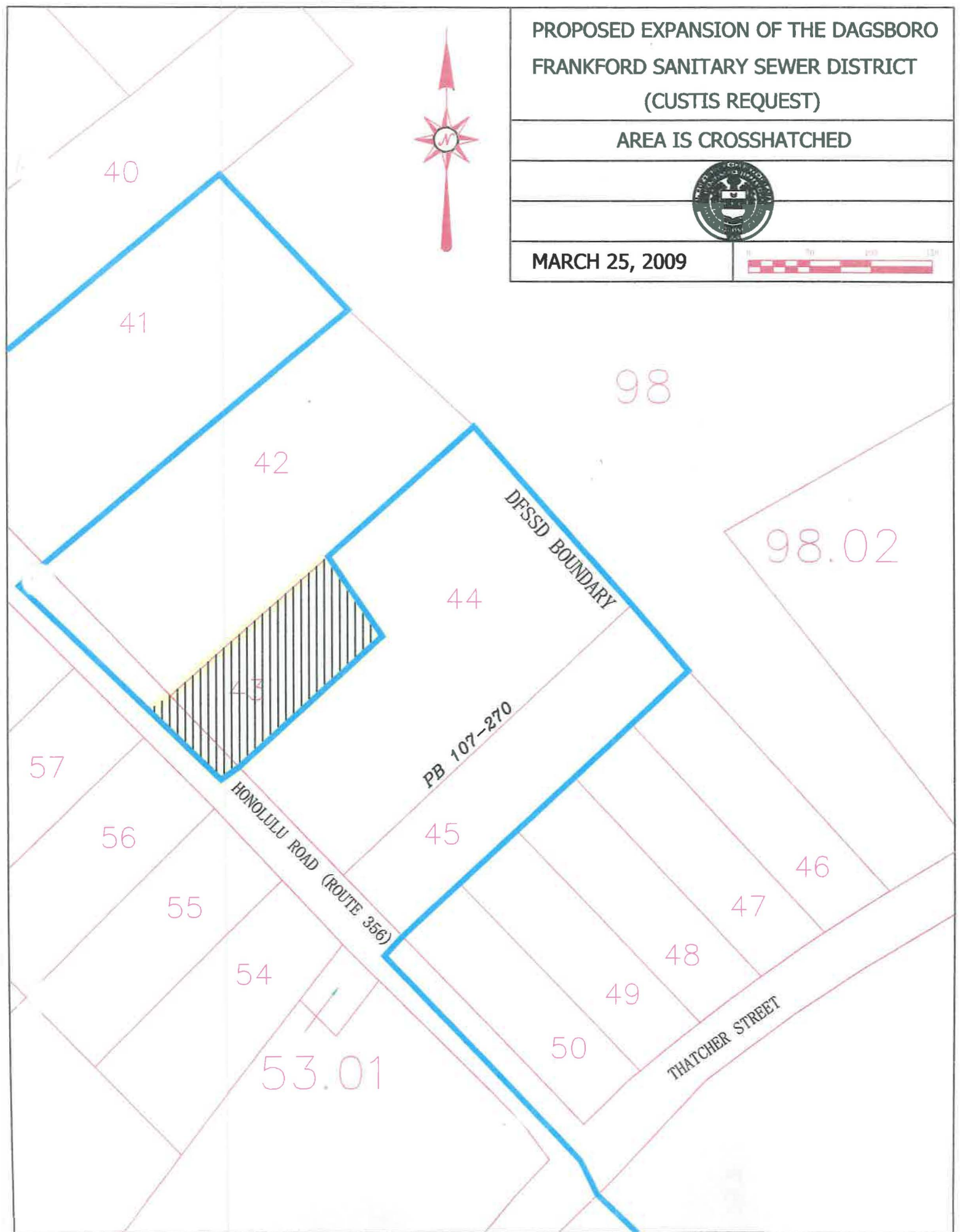

MARCH 25, 2009



PROPOSED EXPANSION OF THE DAGSBORO
FRANKFORD SANITARY SEWER DISTRICT
(CUSTIS REQUEST)

AREA IS CROSSHATCHED



MARCH 25, 2009

