

RESOLUTION NO. R 013 00

BAY VIEW ESTATES SANITARY SEWER DISTRICT DECLARED UNDER THE PROVISIONS OF TITLE 9, CHAPTER 65 OF THE DELAWARE CODE

WHEREAS, the eligible voters of the proposed Bay View Estates Sanitary Sewer District approved the creation of the sewer district by a vote of 124 to 32 in an election held on February 24, 2000; and

WHEREAS, Title 9, Delaware Code, Section 6507 requires the County Council to issue a determination of the sewer district within thirty days of its approval by the eligible voters;

NOW, THEREFORE, BE IT RESOLVED that the County Council of Sussex County, Delaware hereby determines that the eligible voters of the Bay View Estates Sanitary Sewer District have approved the creation of said district, that the description of the Bay View Estates Sanitary Sewer District is described in Exhibit "A"; and that the said district is hereby declared to be validly constituted under the provisions of Title 9, Chapter 65 of the Delaware Code; and

BE IT FURTHER RESOLVED that the Sussex County Council directs the County Engineer and the Attorney for the County Council to procure the necessary lands and rights-of-way by purchase, agreement or condemnation in accordance with the existing statutes; and

BE IT FURTHER RESOLVED that the County Engineer is hereby directed to prepare maps, plans, specifications and estimates, elect contracts for and supervise the construction and maintenance of, or enlarging and remodeling of, any structures required to provide for the safe disposal of sewage in the sanitary sewer district; and

BE IT FURTHER RESOLVED that the Sussex County Council directs the County Finance Director and the County Engineer to apply for, accept, and receive grants, loans, and other funding necessary to provide adequate financing for the planning, design, construction, and all other phases of the sanitary sewer district.

I DO HEREBY CERTIFY THAT THE FOREGOING IS A TRUE AND CORRECT COPY OF RESOLUTION NO. R 013 00 ADOPTED BY THE SUSSEX COUNTY COUNCIL ON THE 29TH DAY OF FEBRUARY, 2000.



ROBIN A. GRIFFITH
CLERK OF THE COUNTY COUNCIL

Exhibit "A"

Description of the Bay View Estates Sanitary Sewer District

BEGINNING at a concrete monument placed on the southern right-of-way of Sussex County Road 395; said concrete monument being approximately one-half mile south of the intersection of Road 395 and Route 54 (formerly Road 58); thence from said place of beginning and by and with the center of a ditch the following four courses: South 43° 03' 23" West 650.81 feet; thence South 34° 26' 27" West 421.42 feet; thence South 06° 57' 40" West 409.44 feet; thence South 04° 18' 33" East 297.98 feet to a concrete monument; said concrete monument being situate on the State of Delaware southern boundary line; thence by and with said boundary line in a westerly direction 1,834 feet more or less to a concrete monument; thence North 11° 40' 38" East 1,100.80 feet to a marked Oak Tree; thence North 26° 25' 48" East 709.06 feet to a concrete monument; thence South 52° 05' 03" East 366.05 feet to a concrete monument; thence North 44° 49' 43" East 1,207.526 feet to a concrete monument and the aforesaid southern right-of-way of Road 395 thence by and with the said southerly right-of-way 41° 47' 09" East 1,017.02 feet to the point of curve in said road; thence by and with the right-of-way of said curve of road (having a radius of 747.165 feet, a delta of 29° 59' 02", an arc of 391.005 feet, and a chord bearing and distance of South 26° 47' 38" East) 386.55 feet to the place of BEGINNING.

A map outlining and describing the boundaries of the Bay View Estates Sanitary Sewer District is attached.

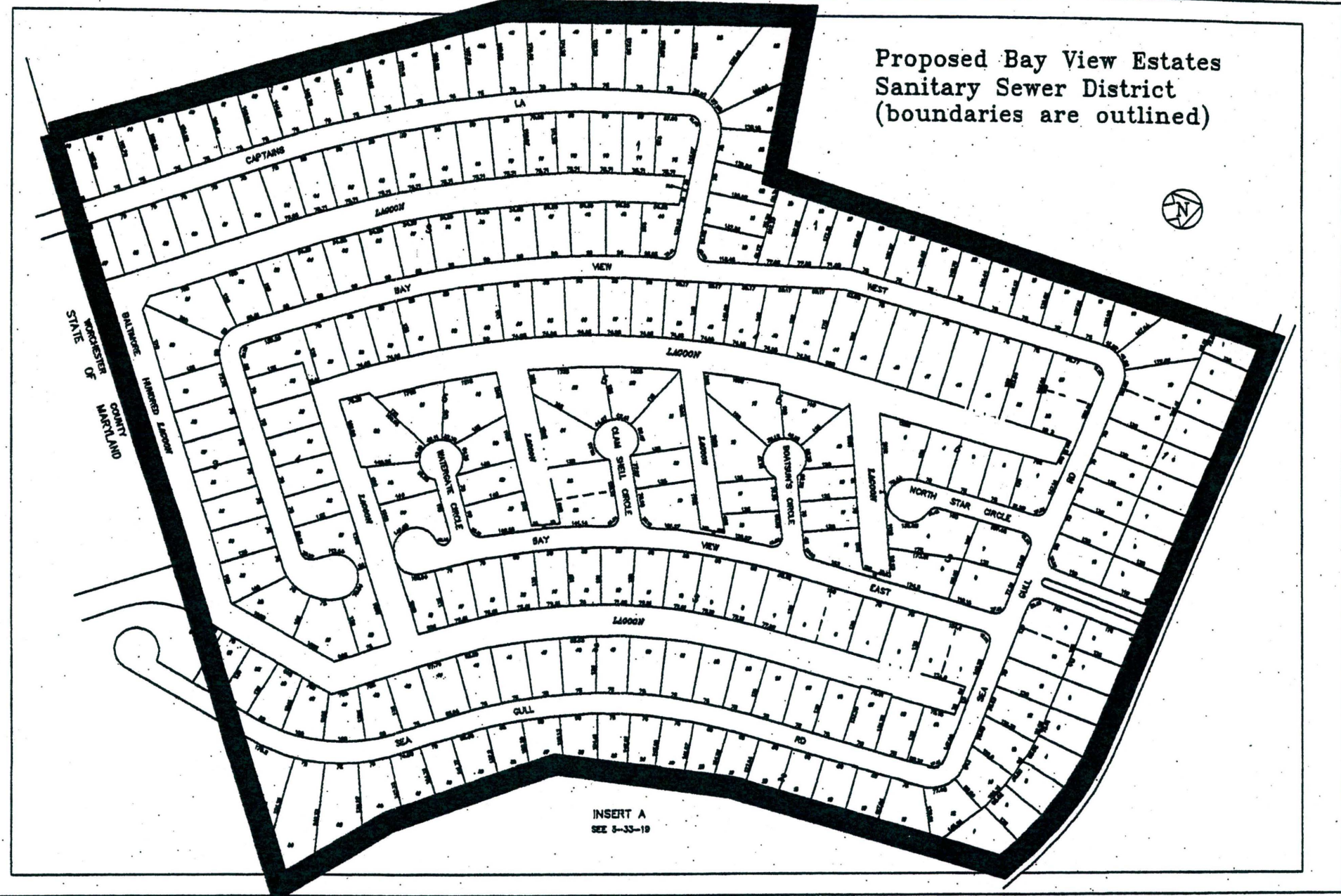

Proposed Bay View Estates
Sanitary Sewer District
(boundaries are outlined)



INSERT A
SEE 5-33-19

DATE OF REVISION: 7-18-99
DATE OF COMPIATION: 04-01-1974
SHEET LAYOUT BASED ON THE DELAWARE
STATE PLANE COORDINATE SYSTEM.

ALL INFORMATION SHOWN HEREON
IS THE PROPERTY OF THE
SUSSEX COUNTY ENGINEERING
DIVISION. IT IS TO BE USED
ONLY FOR THE PROJECT AND
PURPOSE FOR WHICH IT WAS
PREPARED. IT IS NOT TO BE
REPRODUCED OR TRANSMITTED
IN ANY FORM OR BY ANY
MEANS, ELECTRONIC OR
MECHANICAL, INCLUDING
PHOTOCOPYING, RECORDING,
OR BY ANY INFORMATION
STORAGE AND RETRIEVAL
SYSTEM, WITHOUT THE
WRITTEN PERMISSION OF THE
SUSSEX COUNTY ENGINEERING
DIVISION.

SUSSEX COUNTY
DELAWARE
SCALE 1" = 100 FEET

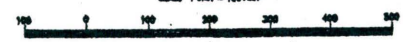

LEGEND	
County Line	Map Parcel Number
Maped Line	Original Lot Number
City or Borough Line	Map Based Dimension
All Easement Line	Dimension Name/Value
Original Lot Line	7
Property Line	All Dimensions Shown in Feet

INSERT SHEET C
MAP: 5-33