

RESOLUTION NO. R 042 86

WHEREAS, a petition was received April 22, 1986 from sixty-five (65) legal voters of the Proposed Long Neck Sanitary Sewer District requesting Sussex County Council to submit the question of organizing a sanitary sewer district to a vote of electors residing in that area; a copy of the proposed district boundaries are attached as Exhibit "B"; and

WHEREAS, a public hearing was held on September 22, 1986 on the question of organizing a sanitary sewer district dealing with the location of the boundaries of the Proposed Long Neck Sanitary Sewer District described in Exhibit "B"; and

WHEREAS, Sussex County Council determined there were no valid reasons for altering the boundaries of the District,

NOW, THEREFORE,

BE IT RESOLVED by the Sussex County Council:

That the establishment of a sanitary sewer district is deemed to be in the public interest and will be conducive to the preservation of the public health; that the area fully described in Exhibit "A" is hereby established as the "Long Neck Sanitary Sewer District".

I DO HEREBY CERTIFY THAT THE FOREGOING IS A TRUE AND CORRECT COPY OF RESOLUTION NO. R 042 86 PASSED BY THE COUNTY COUNCIL OF SUSSEX COUNTY ON THE 30TH DAY OF SEPTEMBER, 1986.

EMOGENE P. ELLIS
CLERK OF THE COUNTY COUNCIL

EXHIBIT "A"

Beginning at a point where the centerline of Guinea Creek meets a bridge on the northern right-of-way (R/W) of County Road 298, thence proceeding with the centerline of said Creek to a point where Guinea Creek discharges to Herring Creek, thence proceeding with an imaginary line in an easterly direction to a point where it meets the centerline of Herring Creek, thence proceeding in an easterly direction with the centerline of said Creek to a point where Herring Creek discharges to Rehoboth Bay, thence proceeding with an imaginary line in a southerly direction to a point where it meets the mean-low water line of the southwestern side of the Rehoboth Bay, thence proceeding in an easterly direction with the mean-low water line of said Bay to a point where it meets the Indian River Bay, thence proceeding in a westerly direction with the mean-low water line of said Bay to a point where it meets the mouth of Lingo Creek at its discharge to the Indian River Bay, then proceeding with an imaginary line in a southerly direction to a point where it meets the centerline of Lingo Creek, thence proceeding in a northwesterly direction with the centerline of said Creek to a point where it meets the eastern property boundary of the parcel of land now or formerly of (N/F) Ethel P. Tunnell and Bonney H. T. Bastholm and Robert W. Tunnell, Jr., thence proceeding in a southerly direction with the easternmost boundary of said property to the point where it meets the property corner of the parcel of land N/F Tunnell Companies, L. P., thence proceeding in a southerly direction with the easternmost boundary of said parcel to a point where it meets the property corner of the parcel of land N/F Jerome W. Hall and Herbert T. Hall, thence proceeding in a southerly direction with the easternmost boundary of said parcel to a point where it meets the northern R/W of County Road 299, thence proceeding in a southerly direction in an extended straight line to the southern R/W of said Road, thence proceeding in a westerly direction with the R/W of said Road to a point where

it meets the northeastern property corner of the parcel N/F Thomas B. and Anna R. Curran, thence in a northerly direction in an extended straight line to the northern R/W of County Road 298, thence proceeding in a northeasterly direction along the R/W of said Road to a point where it meets the southern R/W of County Road 22, thence proceeding in a northeasterly direction in an extended straight line to a point where it meets the northern R/W of County Road 298, thence proceeding in a northeasterly direction along the R/W of said Road to the point of beginning.

The proposed Long Neck Sanitary Sewer District is within these approximate boundaries. A map drawn to scale indicating the boundaries of the proposed Sanitary Sewer District accompanies this notice.

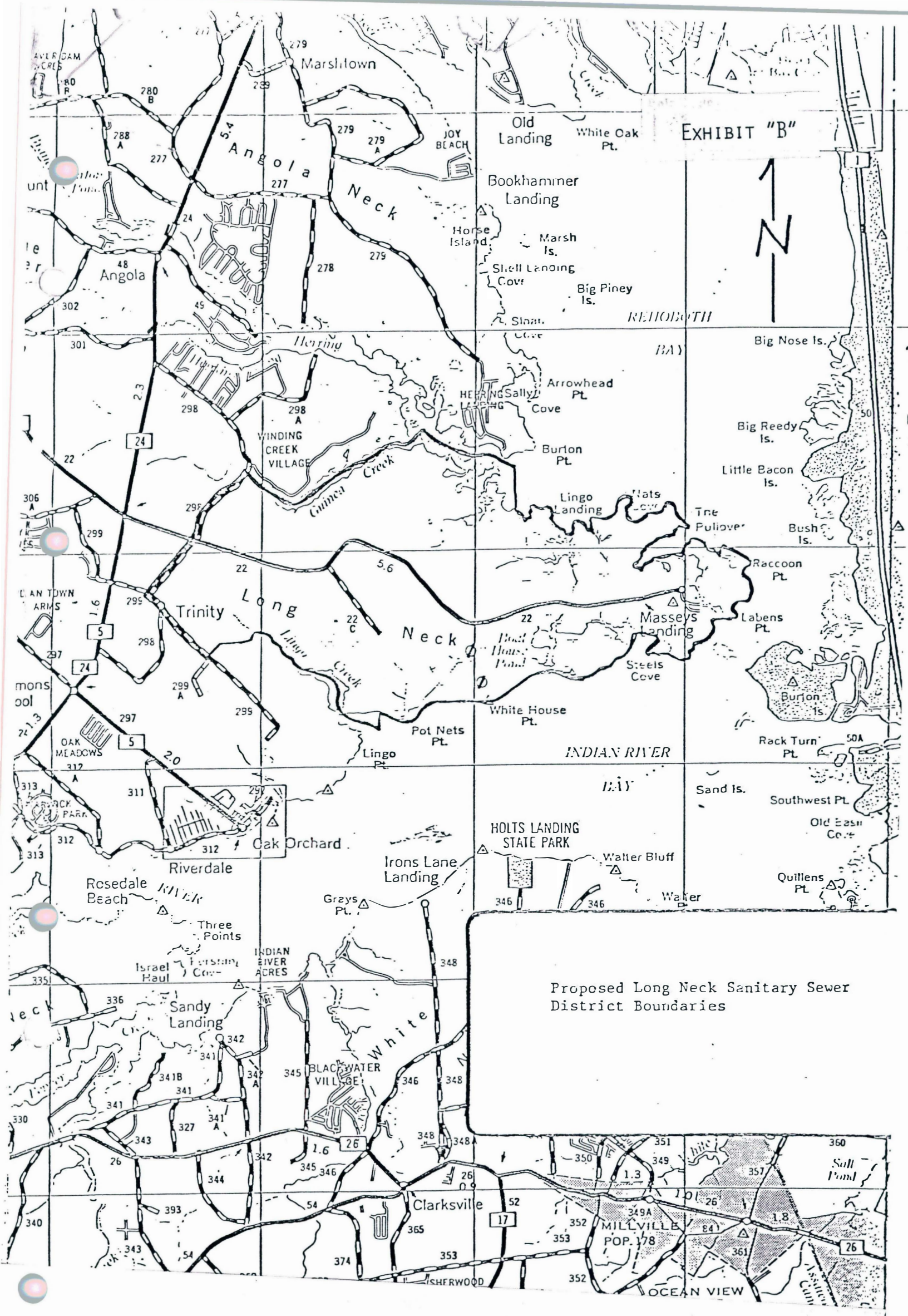

EXHIBIT "B"



Proposed Long Neck Sanitary Sewer District Boundaries